



P.O. Box 1719
 Corona, CA 92878
 Support: 877-512-8111
 www.aFeFilters.com

Intake Kit Installation Instructions: BMW 5 Series 525i,528i & 530i (E39)

Kit Part #	54-10601 (525i-528i) 54-10671 (530i)	Tools Required	Part List:	1	Trim seal 7/16 x 34"
Make:	BMW	8mm socket	1	Filter part # 24-91031 (Replacement filter)	
Model:	5 Series 525i, 528i & 530i E39	5/16" nut driver	1	Housing	
Engine:	L6-2.5-2.8 & 3.0L	10mm socket	2	Spring clips	
Year:	1997-2003	Flathead screwdriver	1	Billet adapter	
		Ratchet and extension	4	M6 x 1 x 10mm button head	
			1	M6 x 1 x 12mm hex head	
			1	M6 flat washer	



Complete kit with parts.

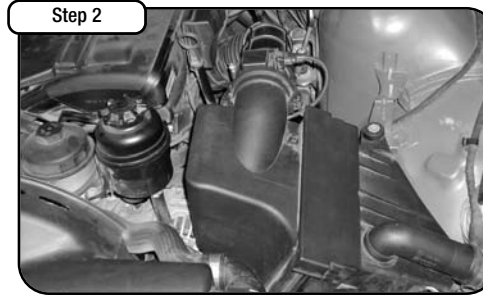

Complete stock intake.

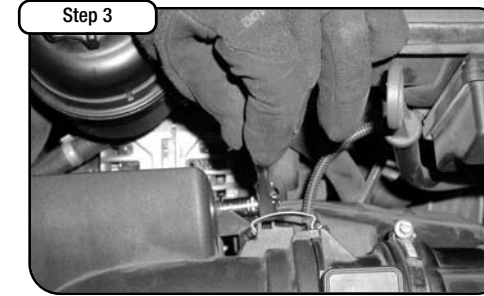

Unclip MAS (Mass Air Sensor) from air box using flathead screwdriver.

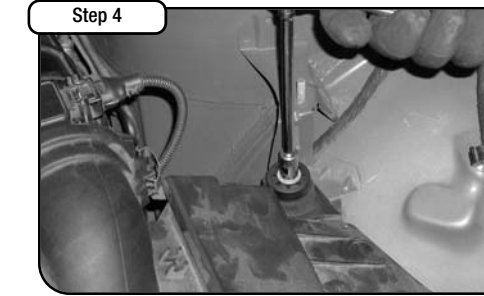

Remove 10mm bolt from side fender.

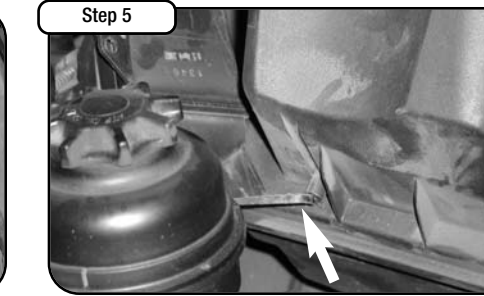

Detach resonator box from stock air box assembly using 8mm socket.



Remove OE air box from vehicle.



Carefully remove o-ring from stock air box.



Install the billet aluminum adapter to the housing using M6 button heads supplied. Install factory o-ring into billet adapter.

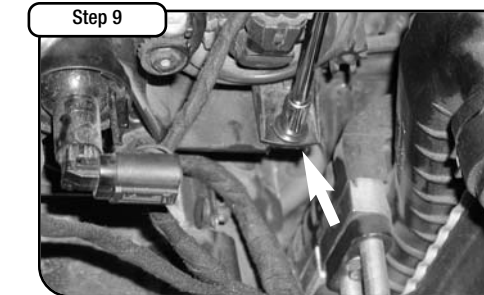

Remove 8mm headlamp support bracket screw.



Install housing into vehicle, making sure to guide MAS into billet adapter.

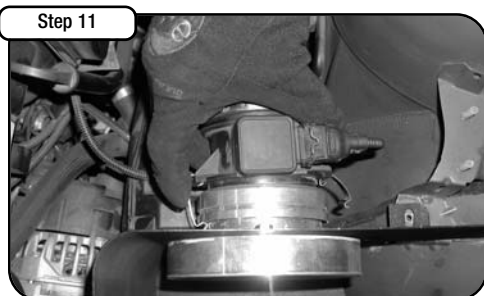

Attach spring clips that are supplied in kit to MAS and clip onto billet adapter.

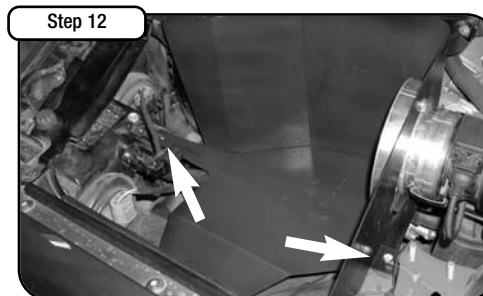

Reinstall 8mm headlamp support bracket screw and use M6 hex head bolt and wavy washer to bolt down backside of housing.



Install trim seal.

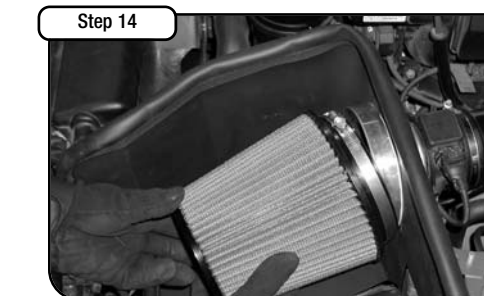

Using a 5/16" nut driver or flat blade screwdriver install pre-oiled aFe filter.

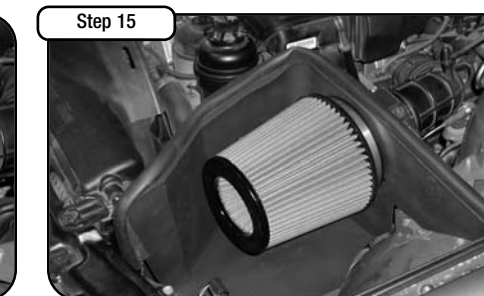

Make sure all hoses and clamps are tight and that all electrical components (if applicable) are secure. Check and retighten connections and filter after a few hours of operation.