

INSTALLATION INSTRUCTIONS AND OWNER'S MANUAL

Thank you for purchasing an ACCESS ADARAC truck and bed rack system. ACI has manufactured this rack with pride using superior quality materials and craftsmanship. With proper care, your rack will provide years of service and enjoyment.

NOTICE TO INSTALLER: It is recommended you take the time to read these instructions before installing this rack even if already familiar with the product. Often improvements are made without prior notice. Always handle rack and components with care to avoid damage. If you find a part missing or defective, or if you are having trouble installing this product, please have serial number ready (found on decal on the driver's side rack rail) and call the customer service number on the back page. **When done, these instructions and warranty information must be given to the consumer.**

NOTICE TO CONSUMER: Before using this product, read the operating instructions, maintenance and safety sections of this owners manual and save for future reference.

FOR YOUR RECORDS:

DATE PURCHASED _____

WHERE PURCHASED _____

SERIAL NUMBER _____

(Located on decal on driver side rail near tailgate)

WARRANTY REGISTRATION

Promptly confirm your warranty by registering online at

www.accesscover.com

HELP LINE



Problems? Questions? Missing or Damaged Parts? Installation Questions?

Visit Us Online First! www.agricover.com/index.php/faq

WARNING

The ADARAC Truck Bed Rack supports cargo overhead while allowing full use of the ACCESS Roll-Up Cover. The ADARAC system has a maximum load capacity of 250 lbs. per cross bar distributed evenly. **DO NOT EXCEED** this capacity. Always secure cargo properly. Failure to secure cargo, or hauling inappropriate cargo may result in personal injury, or death. AGRI-COVER, INC. is not responsible for any property damage, personal injury or death incurred while using any AGRI-COVER, INC product.

CAUTION

This product is only intended for, and only safe for transporting ladders, lumber, pipe and other similar materials. It is the responsibility of the user to secure these materials to the rack before transporting. Never load your rack to exceed the safe capacity of your vehicle. Heavy loads when carried high can dangerously alter the center of gravity of your vehicle. Consult your vehicle's owner's manual for specifications on load ratings and recommendations of installation of aftermarket racks. Any modifications made to this product, or use of this product for any other purpose than its intended use could create a hazardous condition that can cause serious personal injury or property damage.

- NOTICE -

Any modification or unintended use of this product shall immediately void all manufacturers warranties. Manufacturer disclaims all liability for injuries to persons or property resulting from any modification to, or unintended use of this product.

Some vehicle manufacturers require a reinforcing kit, available through the vehicle dealership, to be installed on the truck bed prior to mounting any kind of rack. Contact your dealership to see if your vehicle requires a reinforcing kit before installation.

NOTE: Installation and use of any bed rail mounted accessory may cause minor aesthetic damage to exterior of vehicle. Agri-Cover, Inc. makes no claims or warranties whatsoever as to a particular vehicles ability to support rail mounted accessories without incurring damage. Load capacity of 250lbs. per cross bar applies to ADARAC Truck Bed Rack system only. See your vehicle manufacturer's specifications for bed rail mounted accessories.

1 INSTALLING STAKE POCKET HARDWARE

Tools: Protective Eyewear, 9/16" Wrench, Small Hammer

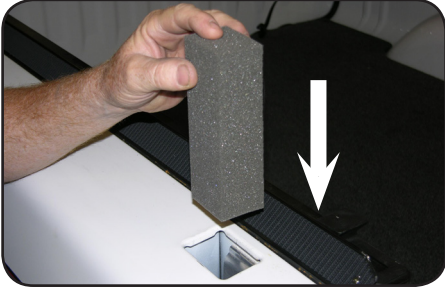

NOTE: Stake pockets must be open to install this product. Remove any accessories or snap-in stake covers if present.

A. Lower foam block clamp support into open stake pocket.

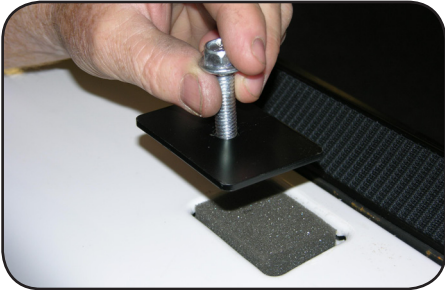

B. Orientate stake pocket clamp plate with smooth side up and thread a bolt ($\frac{3}{8}$ " x $1\frac{1}{2}$ ") on several turns as shown.



C. Maneuver corner of clamp into stake pocket by pushing down on foam and wiggling clamp until all 4 sides are inside of stake pocket.

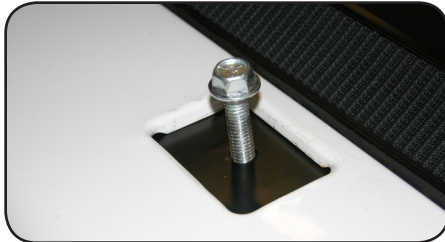

D. Adjust assembly until bolt is centered in stake pocket and clamp is fully supported by foam block. Carefully turn bolt out, allowing foam to support clamp for remaining steps.

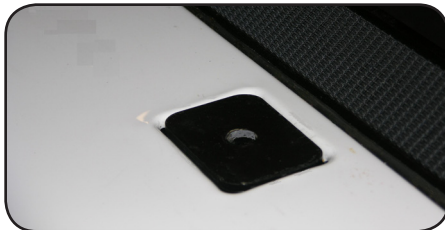

E. Gently place alignment plate(s) directly on top of clamp-holes should line up for bolting later. **NOTE:** Quantity of alignment plates may vary. Always use only enough plates until they set flush with or just slightly lower than top of box rail. Repeat all of step one for remaining stake pockets.

2 MOUNTING RACK RAIL TO BOX



A. Carefully place rack rail (with warning decal) on top of box driver side. Adjust its slotted holes in line with holes on clamping hardware inside stake pockets.

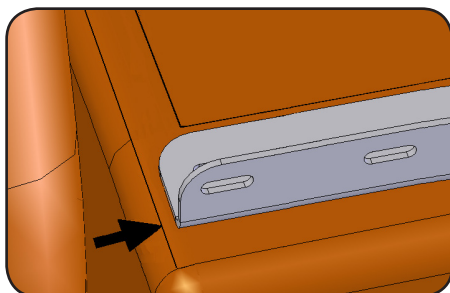

B. Align front of rail close to front edge of box-do not allow rail to go beyond front edge of box.



C. Place flat washer over slotted hole and turn a hex head bolt ($\frac{3}{8}$ " x $1\frac{1}{2}$ "') on until finger tight. Ensure that alignment plate is aligned with stake pocket. Turn bolts in finger tight at remaining stake pockets.



D. Slowly close tailgate to make sure it will not rub against rack rail when closed. (Adjust rack rail forward if needed). Now fully tighten all rack clamp bolts. Repeat steps 1 and 2 for rack rail on opposite side of box.

3 MOUNTING UPRIGHTS TO RACK RAIL

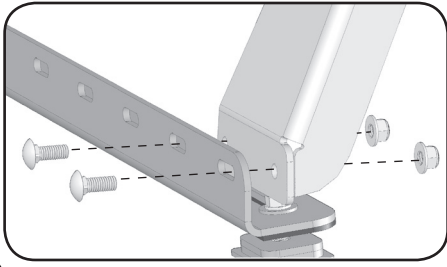

A. Uprights are paired. Mount an upright at rear left side (shown) and front left side (behind cab) to last pair of holes at each end of rack rail. Use 2 carriage bolts with serrated flanged nuts. Turn nuts fully tight now. Repeat procedure on passenger side.

4 MOUNTING FRONT CROSS BAR TO UPRIGHTS

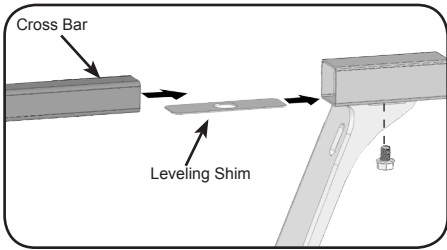

A. At each front upright slide leveling shim inside tube opening and hold them there while sliding cross bar (without ADARAC reflective logo) through each upright. Center bar on both uprights. Align shim hole with bolt hole in upright.

5 CROSS BAR CENTERED AND LEVEL

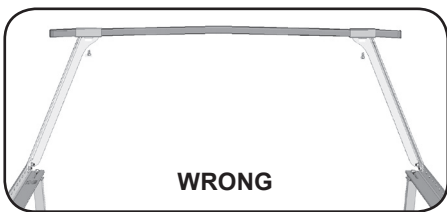

A. **WRONG.** Cross bar centered but with binding between uprights forcing bar to bow up

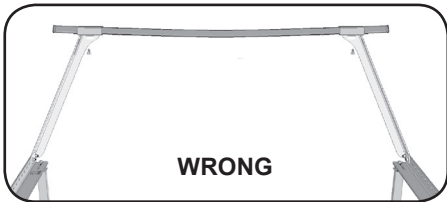

B. **WRONG.** Cross bar centered but with binding between uprights forcing bar to bow down.

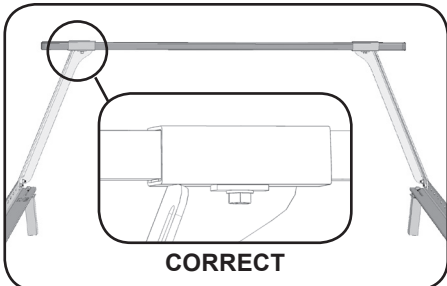

C. **CORRECT.** Cross bar centered without binding between uprights- bar is level and ready for next step.

6 TIGHTEN CROSS BAR BOLTS

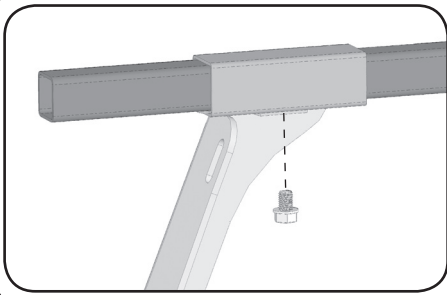

A. Start a Hex Head bolt ($\frac{3}{8}$ " x $\frac{1}{2}$ ") at each upright and turn it until serrated flange tightens up against upright.

7 MOUNTING REAR CROSS BAR



A. Repeat Step 4 shim placement and insert rear cross bar with reflective logo facing out towards rear. Repeat Steps 5 and 6 to finish mounting rear cross bar.

NOTE: Some truck boxes are narrower at the tailgate, therefore when centered, a cross bar at rear may overhang the uprights more than the front.

8 INSERTING BAR END PLUGS

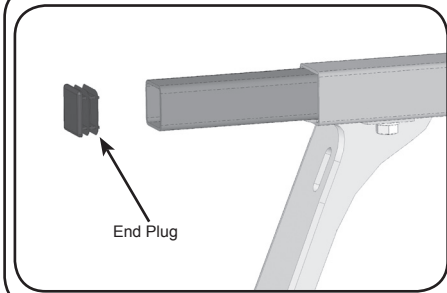

A. At each end of cross bar, tap end plug into tube.

PERIODICALLY CHECK ALL BOLTS AND TIGHTEN IF NEEDED

PARTS DIAGRAM

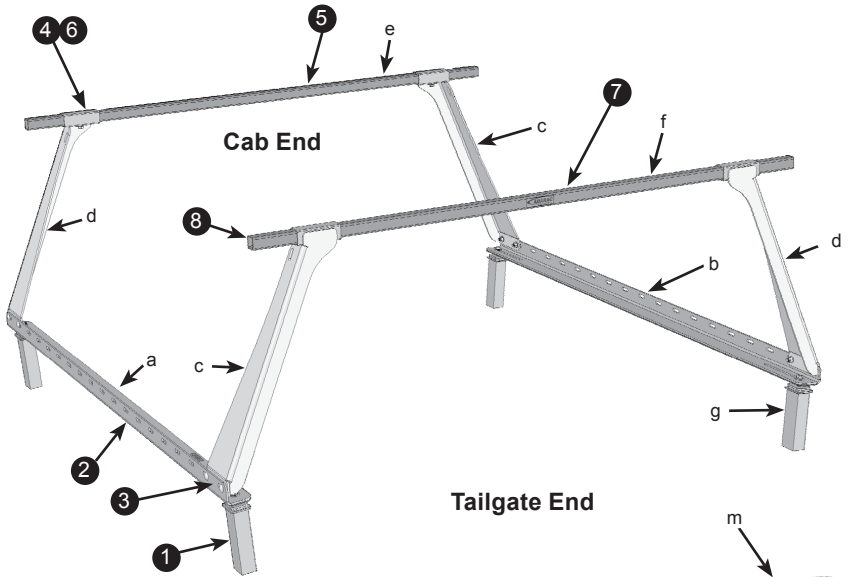

Legend:

- ① – Denotes Step Number
- a – Denotes part description

Parts List:

- a) driver side rack rail (with serial number decal)
- b) passenger side rack rail
- c) left upright
- d) right upright
- e) front cross bar
- f) rear cross bar (with reflective logo)
- g) foam clamp support block
- h) clamp plate
- i) alignment plates
- j) $\frac{3}{8}$ " x $1\frac{1}{2}$ " Hex HD bolt with flat washer
- k) $\frac{3}{8}$ " x 1" carriage bolts with serrated flange nuts
- l) $\frac{3}{8}$ " x $\frac{1}{2}$ " hex head serrated flange bolts
- m) leveling shims
- n) end plugs

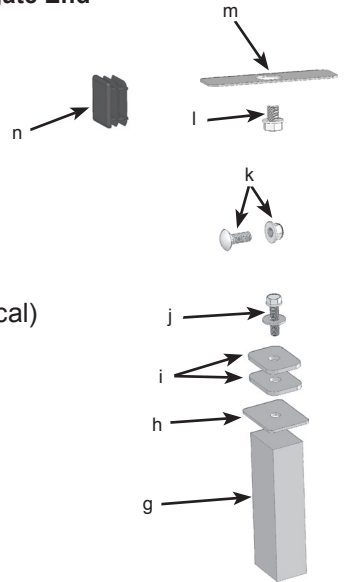

MANUFACTURER'S LIMITED WARRANTY

Agri-Cover, Inc. extends the following limited warranty to the original retail purchaser of any ADARAC™ Truck Bed Rack System:

Agri-Cover, Inc. warrants to the original purchaser, for a period of one (1) year from the date of purchase of the rack, that its ADARAC™ Truck Bed Rack System is free from defects in material and workmanship, as long as the original purchaser owns the truck on which the rack was originally installed and as long as the rack remains continuously installed on said truck.

Agri-Cover, Inc.'s sole obligation under this limited warranty is limited to the repair or replacement, at its option, of defective parts only. No labor or service allowance is given or implied. **INNO EVENT SHALL AGRI-COVER, INC. BE LIABLE FOR INCIDENTAL, CONSEQUENTIAL, OR SPECIAL DAMAGES. AGRI-COVER, INC. EXPRESSLY DISCLAIMS ANY AND ALL IMPLIED WARRANTIES OF MERCHANTABILITY, AND THERE ARE NO WARRANTIES WHICH EXTEND BEYOND THE LIMITED WARRANTY DESCRIPTION CONTAINED HEREIN.**

For warranty performance, call our Customer Service Department at 701-251-1427 to determine if only a replacement part is needed or if the rack needs to be returned for inspection and repair. **Warranty registration must be on file and/or proof of original purchase (detailed and dated receipt) required for warranty to be effective. Goods to be returned must have a pre-authorized RA # (Returned Authorization Number) - obtained by calling the number above.** Mark the number on the package and ship it freight prepaid to address below. Agri-Cover, Inc. will pay freight to return goods to sender.

This limited warranty does not cover any damage due to accident, abuse, misuse, alteration, neglect, improper installation, or ordinary wear and tear.

This limited warranty gives you specific legal rights and you may have other rights, which vary, from state to state.



Agri-Cover, Inc.
Customer Service Dept
3000 Hwy 281 SE
PO Box 508
Jamestown, ND 58402
Phone: 701-251-1427

ACCESS - A Division of Agri-Cover, Inc.

**PHONE 701-251-1427 7:30 am - 5:30 pm Central Standard Time
Monday thru Friday except Holidays**

You May Also Be Interested In Our SnowSport Utility Plows

3 DISTINCT MODELS TO CHOOSE FROM



- Simple bolt on install, mounts in minutes
- No electric or hydraulic components to freeze or malfunction
- Won't scratch concrete or pavers, remove gravel or turf
- Easy storage between snowfalls or during off season
- Made model specific for your application
- Fits trucks, suvs, atvs, utvs, zero turn mowers and more

RUST RESISTANT BLADE



Heavy duty, corrosion-resistant, anodized aluminum blade repels rust, so it never needs painting.

TURF FRIENDLY



Built in trip edge won't scratch concrete, brick or black top, tear up grass surfaces or remove gravel.

NO EXTRA LIGHTS



The practical design does not block headlights in plow or transport position.

EASY TO LIFT



Our plows are easily lifted by one person. Lower the blade, plow until finished, then lift the blade back to transport position.

Call or go online to get yours today!

HOW THE SNOWSPORT PLOWS OPERATE

LIFT BLADE



To begin plowing, remove pin, lift blade one end at a time and lower it over push frame, then replace the pin.

DRIVE FORWARD

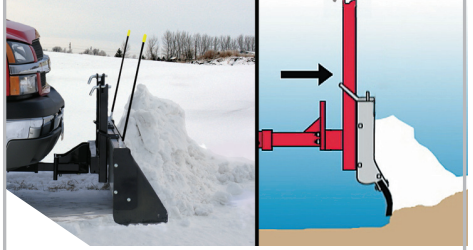

The blade is guided by a push frame that allows it to slide up and down with the grade of the terrain.

BACK UP

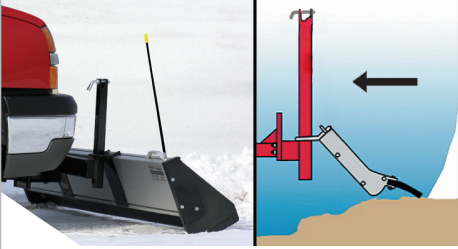

When backing up, the blade lies back, skimming over the ground. When driving forward, blade automatically re-engages for plowing. All you do is drive.

LIFT BLADE WHEN DONE



When finished plowing simply remove pins and lift one end at a time into holders and secure with pins. It's that easy!

"I love this plow! First thing I'm asked is does it work? And then, where did you get this? We get some crazy weather here in Michigan, we can get snow every day and sometimes we get snow all at once, this plow handled all of my conditions wonderfully. Once my neighbors saw that this plow did not ruin the grass or move away all of the stones on the driveway, I was asked if I could plow their areas."

Bob Werbrouck
Fenton, MI

"My first use of the Snow Sport 180 came after a 14" snow fall. It worked Great! It took about 20 minutes to get the hang of driving backwards and pushing snow but after that I have recommended to friends and coworkers to check them out. Took an hour to plow what would have taken me 4-5 hours to blow with a 10 hp snow blower.

Great product!"
Barry R Bender
Dillsburg, PA

"I bought the 6 ft. plow for my 2009 Yamaha Rhino 450 and one word - Awesome!! I am critical of any product but this one is up to snuff. Performs just like described and better."

Doug Parks
Cambridge, MD

888-353-3921

mysnowsport.com

Check out our Accessory Products

The perfect complement to your roll-up cover purchase.

Access™ EZ-Retriever®



Easily grab items that slid to the front of your truck bed from driving.

Works great for pushing items to the front of the truck bed.

Extends to 5' 9". Easily adjusts to the perfect length for any size bed.

Access™ TrailSeal® Tailgate Gasket



Seals gaps around the perimeter of the tailgate.

Prevents dust, rain and snow from entering through the tailgate.

The tailgate does not tightly seal without Access™ TrailSeal®.

Access® Truck Bed Pockets HD



6" tall diamond tread, aircraft grade aluminum.

Allows you to store gear at the rear of the truck bed.

Allows full space between wheel wells.

Access™ Total Bed Seal



Seals gaps in the box of 07-10 GM/Chevy new body truck beds.

Prevents dust, rain and snow from entering the truck bed.

The kit works with tonneaus, toppers and lids.

Access® Truck Bed Pockets G2



5" tall, galvanized with a smooth, polished finish.

Creates extra storage from wasted space.

Provides easy accessibility to cargo at the rear of the truck bed.

Formula 2 Tonneau Cleaner



Water-based spray cleaner that conditions, cleans, and protects.

20 oz. plastic spray bottle.

No oily mess and no destructive silicone.

Access Cargo Management HD & G2

Access® Truck Bed Pockets and Access™ EZ-Retriever® combined in one Cargo Management Kit.

Prevents items from sliding to the front of the bed.

Available in both Access® Truck Bed Pockets HD and G2.



Get Yours Today!

888-353-3921

accesscover.com

