



YOSHIMURA

RESEARCH&DEVELOPMENT OF AMERICA, INC.

5420 DANIELS STREET STE A, CHINO CA., 91786 · (800)634-9166 · (909)628-4722 · FACSIMILE (909)591-2198

www.yoshimura-rd.com

RS-3 OVAL PERFORMANCE EXHAUST SYSTEM

**YAMAHA
2001-05
RAPTOR**

2387600-SA

STAINLESS STEEL COMPETITION SLIP-ON SYSTEM WITH STAINLESS STEEL

2387602-SA

STAINLESS STEEL COMPETITION SLIP-ON SYSTEM WITH CARBON FIBER

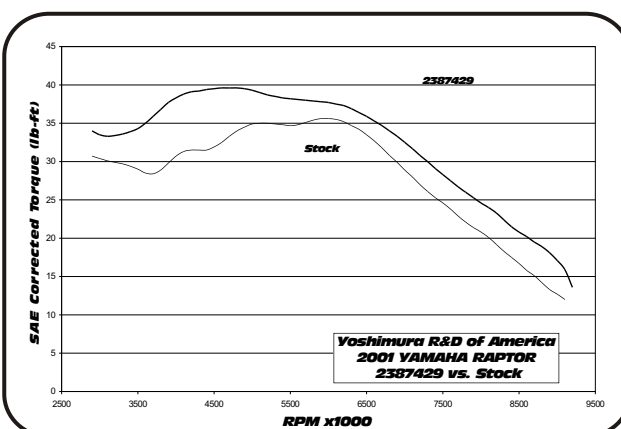
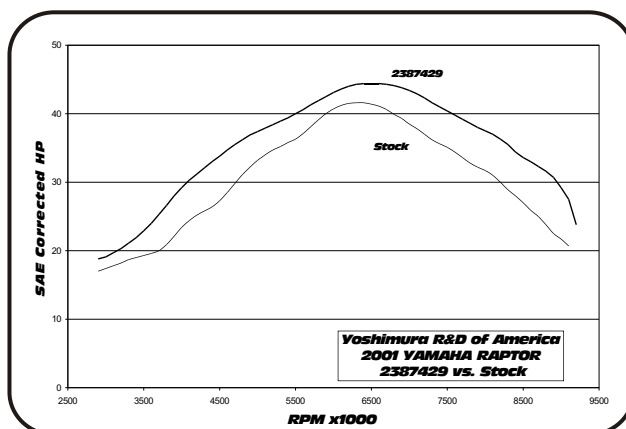

Note: Dyno graphs are for comparison use only. Actual results may vary depending on operating and motorcycle condition.



THIS PRODUCT IS DESIGNED FOR USE IN CLOSED COURSE RACING AND IS NOT INTENDED FOR ANY OTHER USE.



CAUTION: The muffler packing on this system **MUST** be replaced every 6-8 hours of use, or after each moto. Failure to follow recommended muffler re-packing interval can cause muffler damage and may void the warranty.



NOTE: IN THE STATE OF CALIFORNIA, IT IS ILLEGAL TO MODIFY THE EMISSION CONTROL SYSTEM. WHICH INCLUDES THE CARBURETORS OF ANY VEHICLE.

Caution: Exhaust system can be extremely hot. Let motorcycle cool down before beginning installation.

Note: Read through all instructions before beginning installation.

Tools Needed:

12mm socket
3/8" ratchet and extension
11mm(or 7/16") wrench
Torque wrench

Installation Steps:

- 1 Unbolt and remove stock slip-on muffler. (See Fig.1)
- 2 Slide exhaust clamp onto inlet of tail-pipe. Loosely, and install slip-on onto stock header.
- 4 Apply heat insulator to inside of muffler clamps then slide clamps onto muffler.
- 5 Mount muffler clamps to chassis using supplied bolts, washers and spacers. (See Fig.2&3)
NOTE: Mufflers with a Carbon Fiber Sleeve **MUST** use the supplied spacer between the muffler clamp ears. Torque bolt to 2.5 kg-m (18 lb-ft).
- 6 Torque exhaust pipe clamp to 1.25 kg-m (9 lb-ft).
- 7 It is recommended that the slip-on system be wiped down with rubbing alcohol to remove oil and fingerprints. This will help prevent tarnishing of the finish after the exhaust is heated up.
- 8 Before starting engine check for proper clearance between new exhaust system and chassis body work or any moving parts. (i.e. rear brake, frame, tire, bodywork etc.) If any problem is found, please carefully follow through the installation steps again. If problem still persists, please call Yoshimura technical department at (800)634-9166, in CA (909)628-4722.

NOTE: After starting motorcycle, it is normal for new exhaust system and muffler to emit smoke until oil residue burns off.

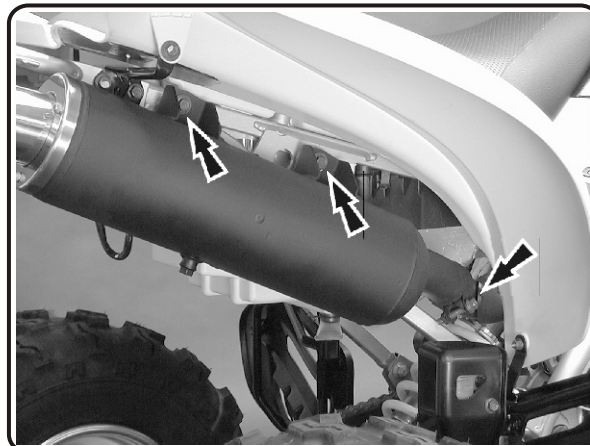

Fig. 1

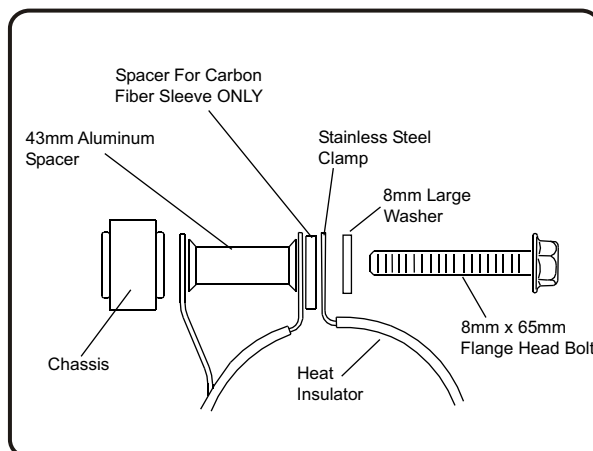

Fig. 2

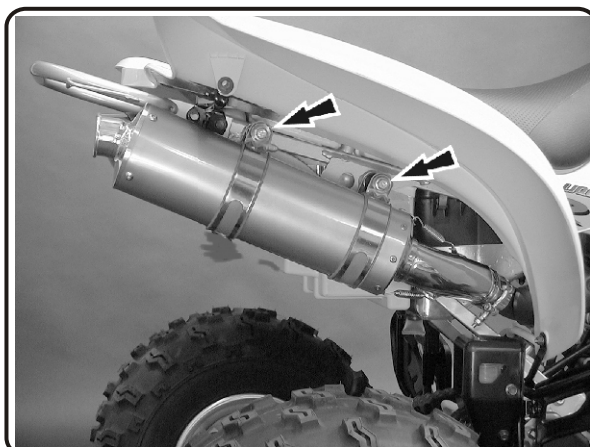
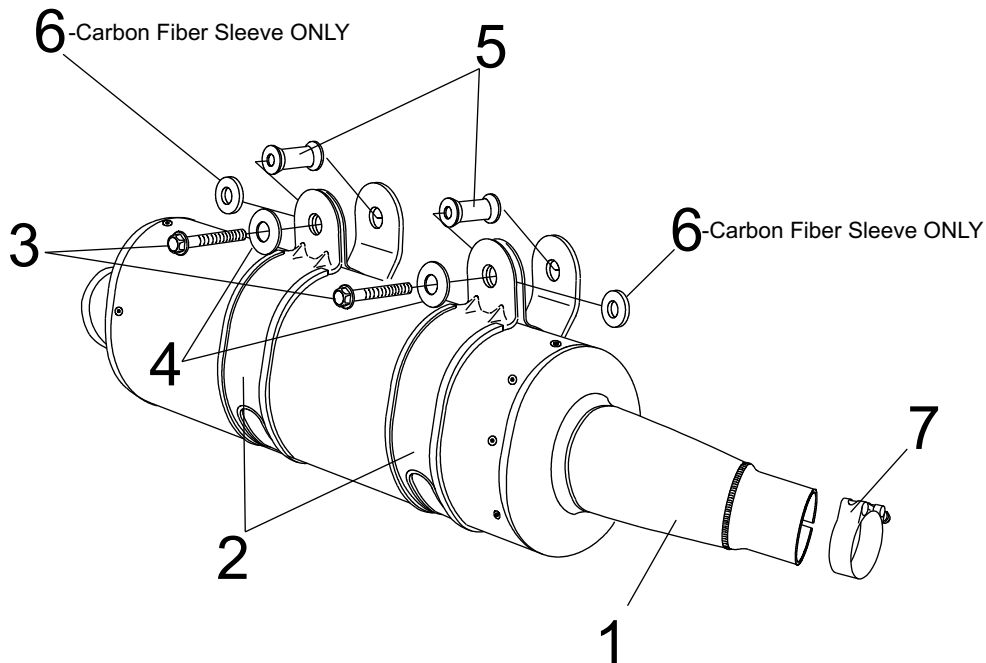

Fig. 3

#2387600-SA/2387602-SA



Parts Diagram

NO.	DESCRIPTION	QTY	PART #
1	Yoshimura Tailpipe with Muffler RS-3 Stainless Steel Competition	1	**
2	Stainless Steel Muffler Clamp	2	COS400S8ASD
3	8mm x 65mm Flange Hex Bolt	2	M8X65H
4	Large Washer	2	8MMWASHERL
5	43mm Aluminum Spacer	2	8MMFS

NO.	DESCRIPTION	QTY	PART #
6	4mm Spacer (Use for 2387602-SA ONLY)	2	8X4SPCR
7	Stainless Steel Exhaust Clamp	1	220-59
**	Muffler Clamp Heat Insulator	2	HT SHLD-14A
**	Yoshimura Vinyl Sticker	1	17029

Nuts and Bolts Guide (Actual Size):

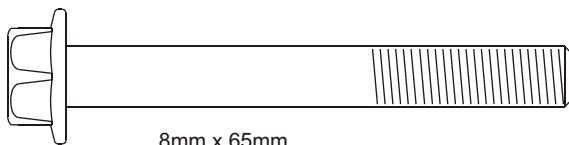

8mm x 65mm
Flange Hex Bolt

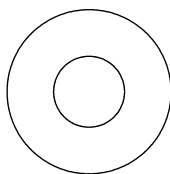

8mm Large Flat Washer



YOSHIMURA

RESEARCH&DEVELOPMENT OF AMERICA, INC.

4555 CARTER COURT, CHINO CALIF. 91710 · (800)634-9166 · (909)628-4722 · FACSIMILE (909)591-2198

www.yoshimura-rd.com

TEC-SA Spark Arrester Cleaning Information

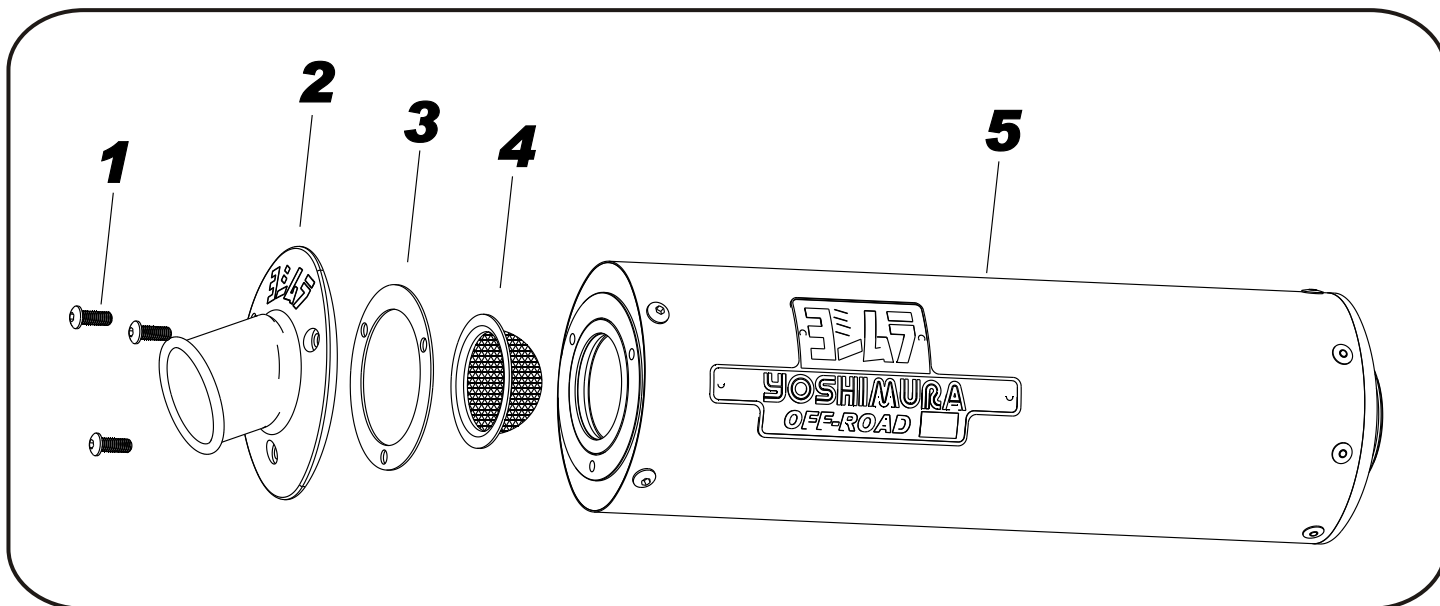

Parts Diagram

Caution: *Muffler can be extremely hot. Let muffler cool down before removing spark arrester.*

Note: *Read through all instructions before beginning disassembly.*

NO.	DESCRIPTION	QTY
1	6 x 1.0mm x 16mm Button Head Screw	3
2	4.0" YRD End Cap, Cover	1
3	T.E.C. End Cap, Gasket	1
4	T.E.C. End Cap, Spark Arrester	1
5	Muffler Assembly	1

Tools Needed:

4mm Allen Key
Wire Brush
Pair of Gloves
Safety Glasses

Cleaning Steps:

1 Using a 4mm Allen key remove the three 6mm x 16mm Button Head Screws located in the muffler end cap. (See Parts Diagram for location)

2 Remove the end cap, gasket and spark arrester from the muffler.

3 Using a wire brush remove carbon deposits from spark arrester screen. Once clean inspect the screen for excessive wear or damage, if any is found the spark arrester must be replaced. Cleaning and inspection should be performed after every 60 hours of use.

(Caution: Gloves and Safety Glasses should be worn while cleaning spark arrester.)

4 Re-install spark arrester, gasket, end cap and 6mm x 16mm screws into muffler assembly. Torque screws to 1.0 kg-m (7.3 lb-ft)

(Note: It is recommended that a low strength "Loctite" is used on the screws.)