

S62240

03-07 FORD F250/F350 6.0L
POWERSTROKE, TURBO BACK,
5" SINGLE SIDE

MBRP

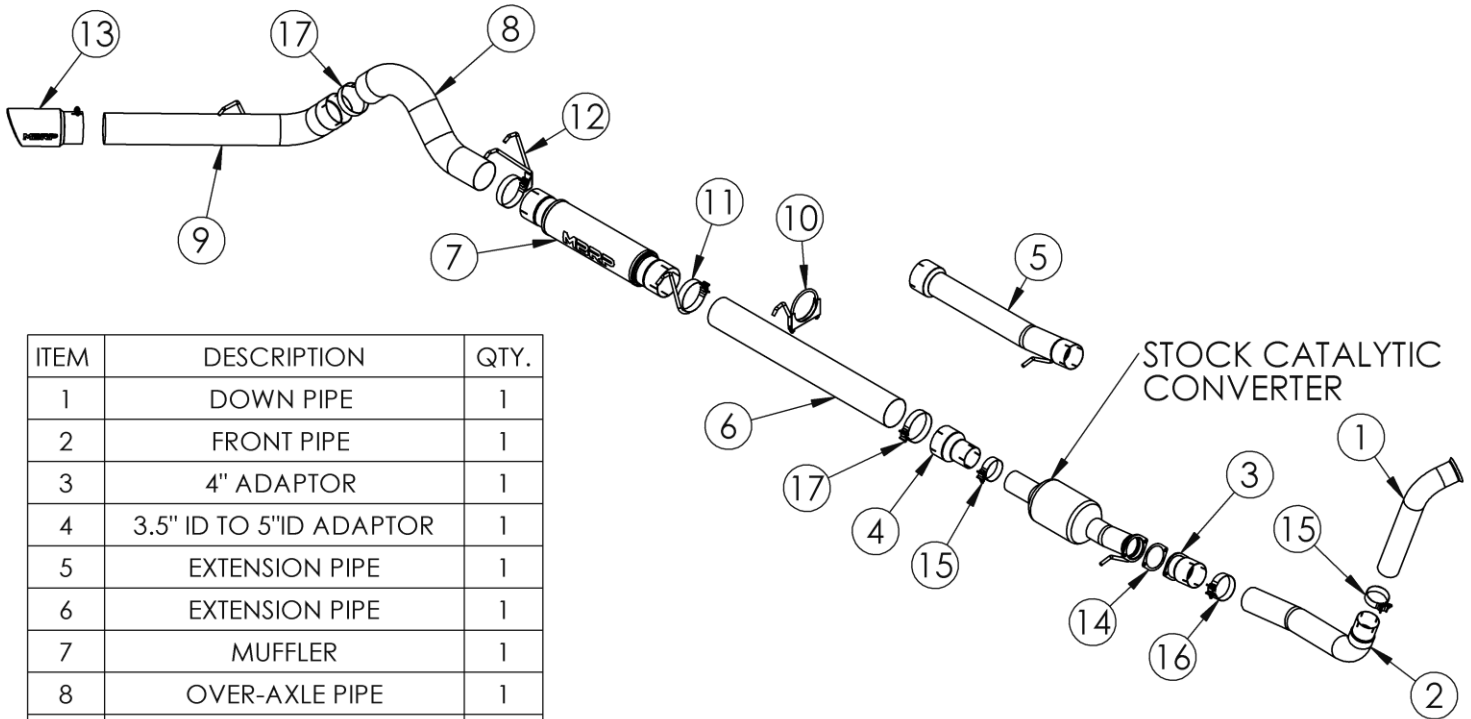

ITEM	DESCRIPTION	QTY.
1	DOWN PIPE	1
2	FRONT PIPE	1
3	4" ADAPTOR	1
4	3.5" ID TO 5"ID ADAPTOR	1
5	EXTENSION PIPE	1
6	EXTENSION PIPE	1
7	MUFFLER	1
8	OVER-AXLE PIPE	1
9	TAIL PIPE	1
10	HANGER CLAMP	1
11	BAND HANGER CLAMP	1
12	BAND HANGER CLAMP	1
13	EXHUAST TIP	1
14	GASKET	1
15	3.5" BAND CLAMP	2
16	4" BAND CLAMP	1
17	5" BAND CLAMP	2

PLEASE READ BEFORE STARTING INSTALLATION

While MBRP Inc. has made every effort to ensure that all components of this system are of superior quality and properly packaged, it is the installer's responsibility to ensure the following before removal of the factory exhaust:

- that ALL components shown above are present.
- that ALL mating components fit together.
- that there are no damaged components.
- that the system you have purchased is appropriate for your vehicle year, model and configuration.
- that the system will not interfere with any modifications previously installed or planned.
- that you have read and understand these instructions.

If you have any questions or are uncertain about any aspect of the installation of this system to your vehicle please contact your dealer before commencing installation.

MBRP

Removal of Stock System:

1. Apply a penetrating lubricant liberally to all exhaust fasteners, hangers and rubber insulators.
2. Loosen the nut on the band clamp located behind the catalytic converter using a 15mm wrench or socket.
3. Remove the muffler and tail pipe from the OEM rubber hangers. To remove the system in one piece, on 03-04 models, the bottom shock bolt of the passenger side shock must be removed. **This is not required on 05 or 06 models.** Separate the stock exhaust at the slip joint located behind the catalytic converter and remove the muffler and tail pipe from under the truck. Re-install the bottom shock bolt.
4. Remove the catalytic converter by removing the two nuts holding the inlet flange together using a 15mm wrench or socket. Retain the nuts for the re-installation of the catalytic converter.
5. Remove the down pipe from the turbo by removing the band clamp using an 11mm socket. Retain the band clamp for the installation of the new down pipe. Cut the down pipe in front of the transmission cross member to remove. (**Note:** The stock down pipe can be removed in one piece by removing the transmission cross member. MBRP recommends that this procedure only be done by qualified, trained professionals using tools and, equipment designed to safely carry out this process.)

Installation of MBRP Performance Exhaust:

Note: Vehicles originally equipped with a catalytic converter must retain the factory catalytic converter. Removal of the catalytic converter may be a violation of federal or local regulations.

1. Install the **Down Pipe** in the same position as the stock down pipe and attach the flared end to the turbo using the stock band clamp. Do not tighten fully until all components are in place.
2. Attach the **Front Pipe** to the **Down Pipe** using a **3.5" Band Clamp**.
3. Attach the **4" Adaptor** to the **Front Pipe** with a **4" Band Clamp**.
4. Attach the factory catalytic converter to the **4" Adaptor** by placing the **Gasket** supplied between the flanges and installing the two nuts that were removed previously.
5. Attach the **3.5" ID to 5" ID Adaptor** to the outlet of the Catalytic Converter using a **3.5" Band Clamp**.
6. Install the **Extension Pipe** into the **3.5" ID to 5" ID Adaptor**. The **Extension Pipe** provided is pre-cut for the Crew Cab Long Bed configuration. All other configurations will require this pipe to be cut.

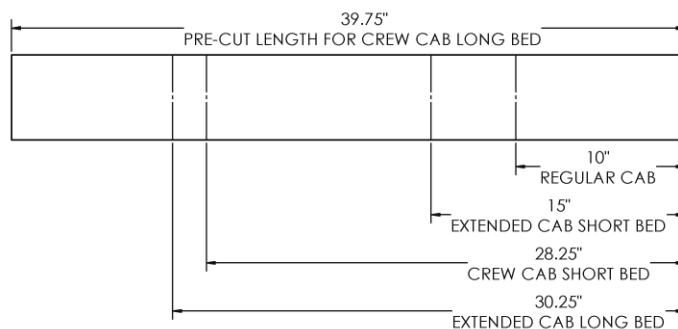

MBRP

7. Install the **Muffler** over the **Extension Pipe**. The **Band Hanger Clamp** is used at the connection between the **Muffler** and the **Extension Pipe** and installed into the OEM rubber hanger at the position. Install the dual-hanger **Band Hanger Clamp** into the two OEM rubber hangers located above the outlet of the **Muffler**.
8. Slide the **5" Band Clamp** and **Tail Pipe** onto the **Over-Axle Pipe**. Install the assembly from the rear of the truck, over the axle and attach to the **Muffler** outlet. Install the **Tail Pipe** hanger into the OEM hanger, then adjust for best axle clearance and **Tail Pipe** exit location to complete.
9. Install the provided clamps around the pipes where needed. Adjust the **Tail Pipe**.
10. Install and adjust the **Exhaust Tip** to suit. Tighten the lock bolt located on the **Exhaust Tip**.
11. Starting at the front of the exhaust, tighten all clamps and connections.
12. Check along the whole length of the exhaust system to ensure that there is adequate clearance around any fuel and brake lines or any wiring. If any interference is detected relocate or adjust.

Congratulations! You are ready to begin enjoying the improved performance and driving experience of your **MBRP** performance exhaust system. We hope you enjoy your purchase.