

S5326P

05-15 TOYOTA TACOMA, 4.0L, EXTENDED/CREW CAB, CAT BACK, 2.5" SINGLE SIDE, EXC. X-RUNNER

MBRP

22-Oct-19

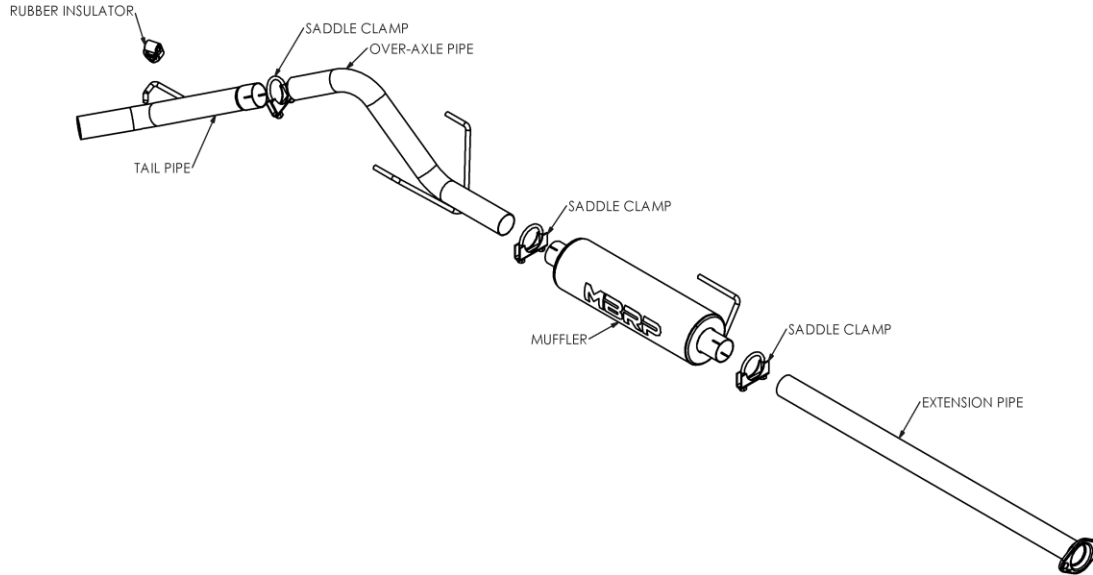

PLEASE READ BEFORE STARTING INSTALLATION

MBRP has made every effort to ensure that all components of this system are of superior quality and properly packaged. It is the installer's responsibility to ensure that all components are present and fit together as shown. Please also ensure that all components are undamaged before removal of the factory exhaust. Finally, check that this system properly matches the make and model of the vehicle and will not interfere with previous or planned modifications.

Removal of Stock System:

1. Apply a penetrating lubricant liberally to all exhaust fasteners, hangers and rubber insulators.
2. Remove the bolts and springs holding the front flange together and disconnect exhaust system. Do not discard this hardware as it is used for the installation.
3. Remove the hangers from the rubber insulators and remove the exhaust from the vehicle. If a hoist or hydraulic lift is not being used the tail pipe may need to be cut to clear the rear axle.

Installation of MBRP Inc. Performance Exhaust:

1. Using the bolts previously removed from the flange slide the springs over the bolts and loosely attach the **Extension Pipe** to the flange using the fasteners. Note: The **Extension Pipe** will need to be cut to 32" for the **Double Cab Short Bed** model.
2. Install the **Muffler** onto **Extension Pipe** using one of the **Saddle Clamps**. Then install the hanger into the factory rubber insulator. Do not tighten the clamp at this time.
3. Loosely install the **Over-Axle Pipe** connecting it to the **Muffler** outlet with a **Saddle Clamp**. Install the hangers into the rubber insulator located above the **Over-Axle Pipe**.
4. Connect the expanded end of the **Tail Pipe** to the **Over-Axle Pipe** with the remaining the **Saddle Clamp**. Install the hanger into the factory rubber insulator. **NOTE: 2013 and newer models require the removal of the factory rubber insulator and the installation of the 90° Rubber Insulator to the outside frame mount.**
5. Make sure that the exhaust is properly in place before tightening clamps. Start at the front of the exhaust system and begin tightening all connections.

Congratulations! You are ready to begin enjoying the improved performance and driving experience of your **MBRP** Performance Exhaust system. We hope you enjoy your purchase.