



YOSHIMURA

RESEARCH & DEVELOPMENT OF AMERICA, INC.

5420 DANIELS STREET STE A, CHINO CA. 91786 · (800)634-9166 · (909)628-4722 · FACSIMILE (909)591-2198

www.yoshimura-rd.com

RS2 PERFORMANCE EXHAUST SYSTEM

HONDA
2005-2012
CRF450X

2254713

RS2 STAINLESS STEEL SLIP-ON WITH ALUMINUM SLEEVE



THIS PRODUCT IS DESIGNED FOR USE IN CLOSED COURSE RACING AND IS NOT INTENDED FOR ANY OTHER USE.



CAUTION: The muffler packing on this system **MUST** be replaced every 6-8 hours of use, or after each moto. Failure to follow recommended muffler re-packing interval can cause muffler damage and may void the warranty.



NOTE: IN THE STATE OF CALIFORNIA, IT IS ILLEGAL TO MODIFY THE EMISSION CONTROL SYSTEM. WHICH INCLUDES THE CARBURETORS OF ANY VEHICLE.

Caution: Exhaust system can be extremely hot. Let motorcycle cool down before beginning installation.

Note: Read through all instructions before beginning installation.

Installation Steps:

- 1 Remove right rear number plate. (See Fig. 1)
- 2 Remove stock muffler and tailpipe.
- 3 Install supplied rubber grommet into Yoshimura muffler mounting bracket. Install aluminum insert into rubber grommet. Ensure shoulder of insert faces toward the frame. (See Fig. 2)
- 4 Slip supplied exhaust collector clamp over Yoshimura tailpipe. Install tailpipe with muffler onto stock header.
- 5 Bolt tailpipe to chassis mount using supplied bolt. (See Fig. 3)
- 6 If muffler mounting bracket does not line up correctly with the stock muffler mount location, refer to page 3 for muffler bracket adjustment instructions.
- 7 Mount muffler to stock muffler mount using supplied bolt and washer. Hand tighten bolt only at this point. (See Fig. 3)
- 8 Torque muffler and chassis mount bolt to 2.5 kg-m (18 lb-ft).
- 9 Torque collector clamp to 1.25 kg-m (9 lb-ft).
- 10 It is recommended that the muffler and tailpipe be wiped down with rubbing alcohol to remove oil and fingerprints. This will help prevent tarnishing of the finish after the exhaust is heated up.
- 11 Check for proper clearance between new exhaust system and rear suspension (i.e. tire, swing-arm, brake, shock etc). If any problem is found, please carefully follow through the installation steps again. If problem still persists, please call the Yoshimura technical department at (800)634-9166, in California call (909) 628-4722.

- 12 Reinstall number plate.

NOTE: After starting motorcycle, it is normal for new exhaust system and muffler to emit smoke until oil residue burns off.



Fig. 1

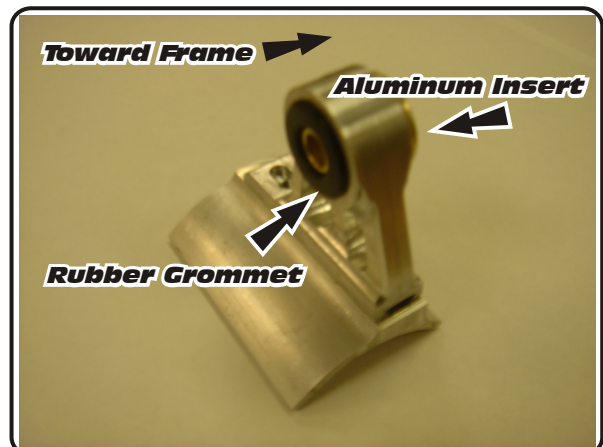

Fig. 2



Fig. 3

Muffler Bracket Adjustment:

- 1 Loosen the muffler bracket locking bolt. (See Fig. 1)
- 2 Slide the muffler bracket until the bolt hole lines up with the stock muffler mounting location on the frame.
- 3 Tighten the locking bolt to lock the bracket into position. (See Fig. 2)

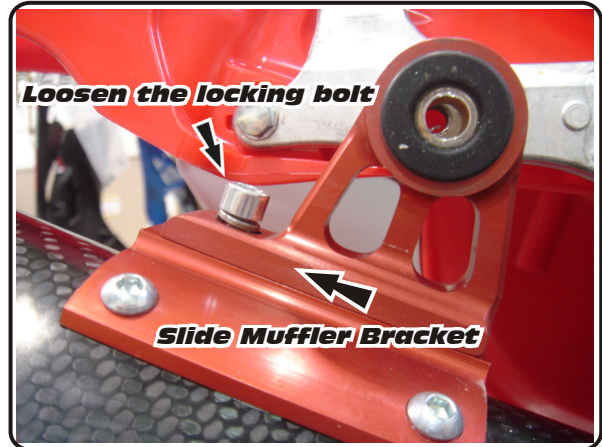

Fig. 1

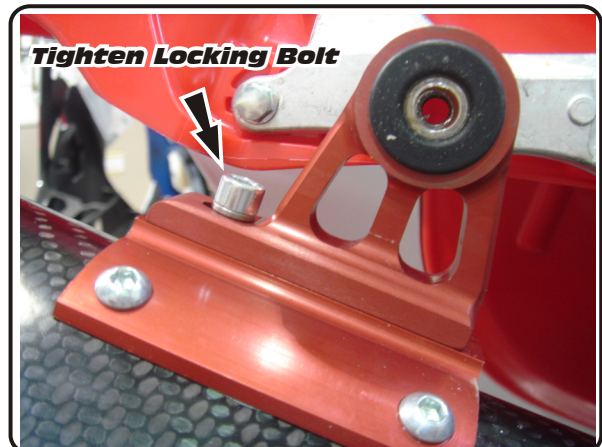
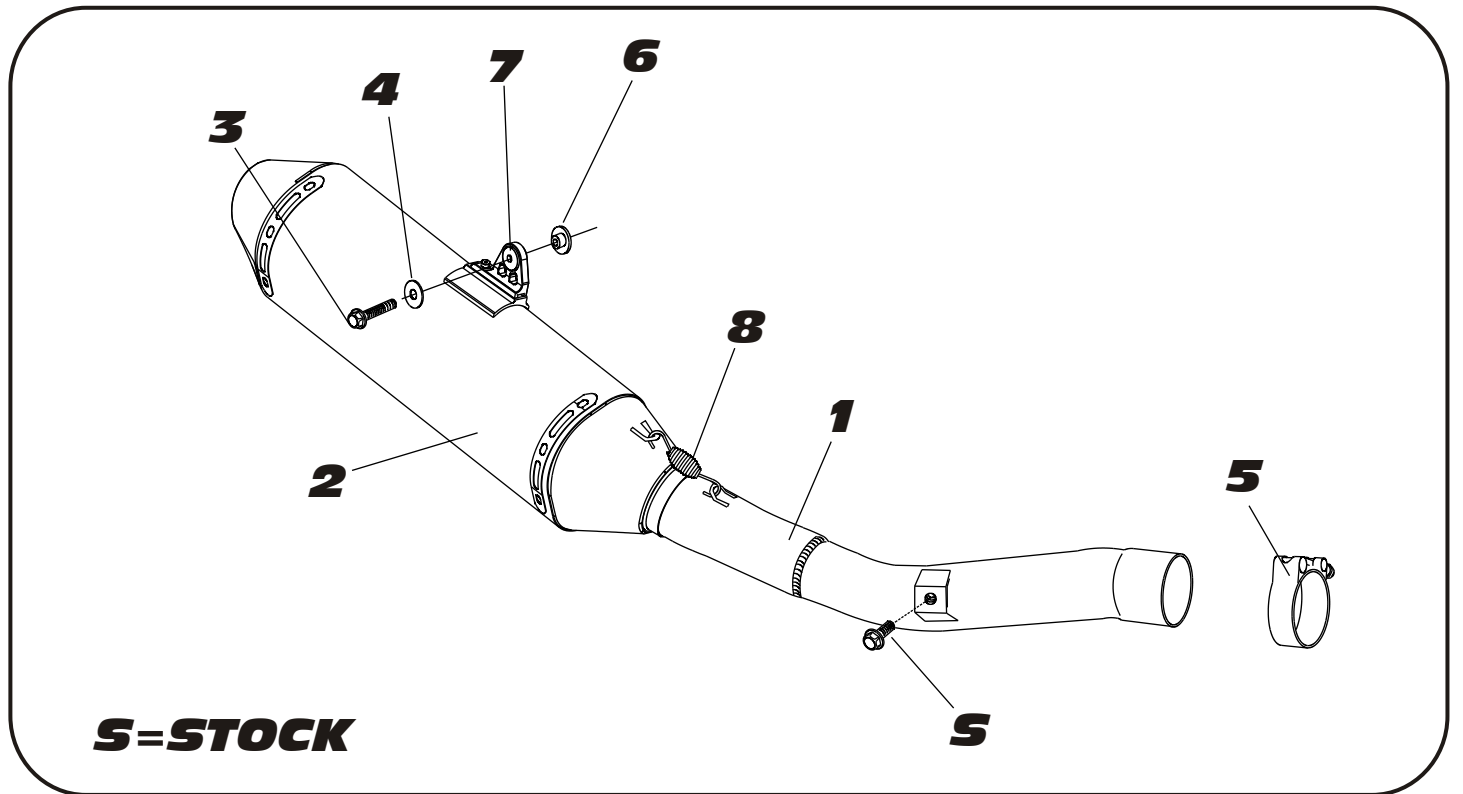

Fig. 2

#2254713



Parts Diagram

NO.	DESCRIPTION	QTY	PART #
1	Yoshimura Stainless Steel Tailpipe	1	2254-152-A
2	Yoshimura RS2 Muffler	1	2254713-RMA
3	8mm X 30mm Flange Head Bolt	1	M8X30H
4	8mm Large Washer	1	8MMWASHERL
5	1.75" Exhaust Clamp	1	22057
6	Aluminum Spacer	1	ALS-003
7	Rubber bushing	1	Z1022
8	Medium Exhaust Spring	2	RACE-SPS-1
**	Offroad Endcap Plug	1	347PLUG
**	Spring Puller Tool	1	ST-200
**	Yoshimura Vinyl Sticker	1	17029



YOSHIMURA

RESEARCH & DEVELOPMENT OF AMERICA, INC.

5420 DANIELS STREET SUITE A, CHINO, CA 91710 · (800)634-9166 · (909)628-4722 · FACSIMILE (909)591-2198

www.yoshimura-rd.com

Spark Arrester Cleaning Information

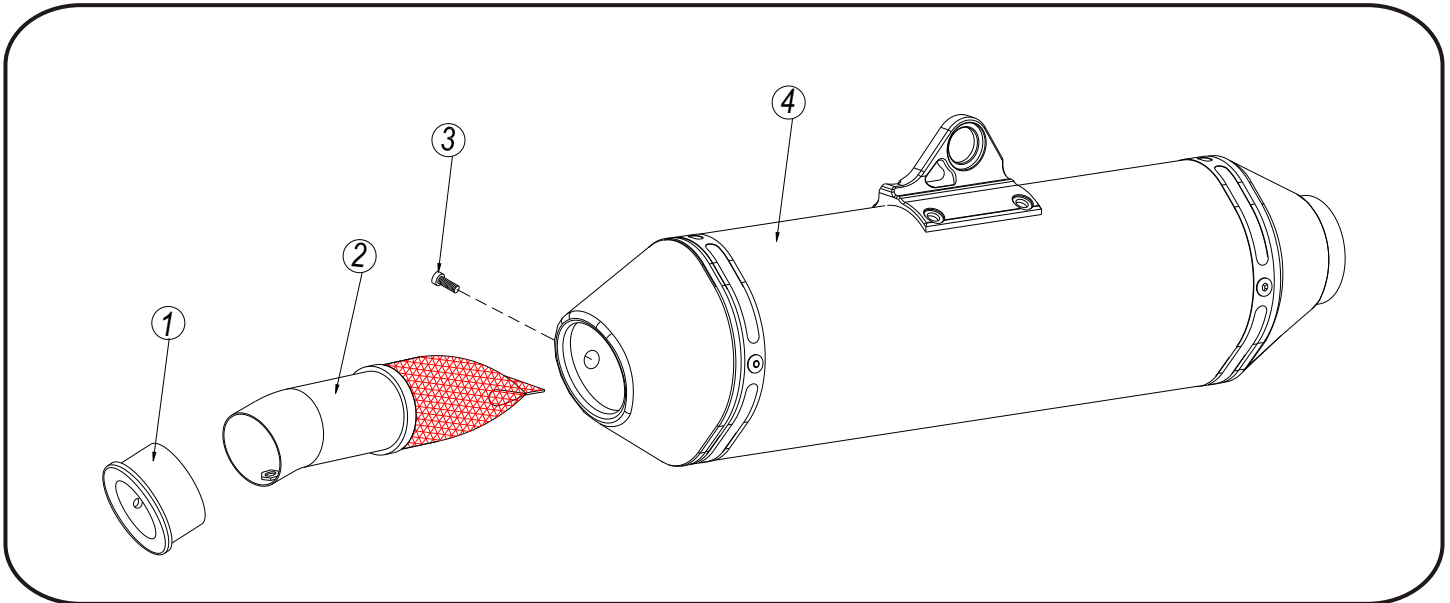

Parts Diagram

Caution: *Muffler can be extremely hot. Let muffler cool down before removing spark arrester.*

Note: *Read through all instructions before beginning disassembly.*

Tools Needed:

4mm Allen Key
Wire Brush
Pair of Gloves
Safety Glasses

Cleaning Steps:

- 1 Using a 4mm Allen key, remove the bolt that secures the aluminum ring and spark arrester to the muffler (see Parts Diagram for location).
- 2 Remove the spark arrester from the muffler.

NO.	DESCRIPTION	QTY
1	Aluminum Ring	1
2	Spark Arrester	1
3	Spark Arrester Securing Bolt	1
4	Muffler Assembly	1

- 3 Using a wire brush, remove carbon deposits from spark arrester screen. Inspect the screen for excessive wear or damage. If spark arrester is excessively worn or damaged, the spark arrester must be replaced. Cleaning and inspection should be performed at the same time as muffler repacking. Repacking is recommended every 8-10 hours of riding or 2 motos, whichever comes first.

CAUTION: *Gloves and safety glasses should be worn while cleaning spark arrester.*

- 4 Re-install spark arrester and aluminum ring. Torque the spark arrester securing bolt to 1.0 kg-m (7.3 lb-ft).

NOTE: *It is recommended that a low strength "Loc-tite" is used on the spark arrester securing bolt.*