



PERFORMANCE EXHAUST SYSTEM

APPLICATION

MAKE	MODEL
KTM	250 SX-F
PRODUCT	
262510D320	RS4 Stainless Steel Full-System Exhaust with Aluminum Sleeve: Carbon Fiber Endcap

	This product is designed for use in closed course racing and is not intended for highway use. In the state of California, it is illegal to modify the emission control system, which includes the fuel injection of any vehicle.
	You must know how to remove and replace your stock exhaust in order to install this product otherwise have it installed by a professional mechanic. Keep all stock parts from your existing system as some components may be necessary to install your new Yoshimura exhaust depending on the application.
	Read through all instructions before beginning installation. Exhaust system can be extremely hot. Let motorcycle cool down before beginning installation. Always wear hand and eye protection and take precautionary measures to avoid injury.
	Always properly support vehicle with a stand and/or lift when servicing or performing any work. Unstable vehicles may present dangerous conditions and may cause property damage, personal injury and/or death.
	The muffler packing on this system MUST be replaced every 6-8 hours of use or after each moto. Failure to follow recommended muffler re-packing interval can cause muffler damage and may void the warranty.

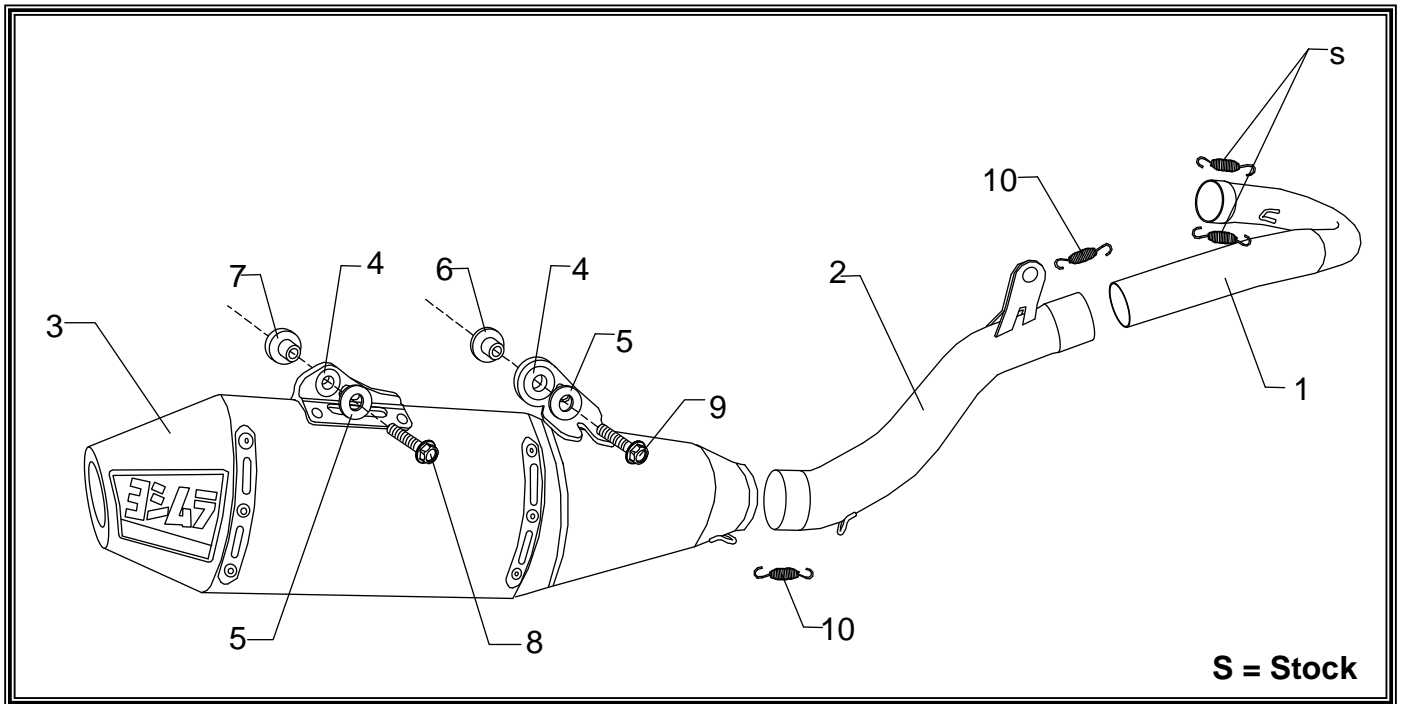

No.	Part #	Description	Qty
1	26251-104	Yoshimura SS Header	1
2	26251-144	Yoshimura SS Tailpipe	1
3	262510D320-RMA	Yoshimura Muffler Assembly	1
4	Z1022	Rubber Grommet	2
5	6MMWASHERXL	6mm XL Flat Washer	2
6	ALS-023	Aluminum Spacer	1
7	ALS-037	Aluminum Spacer	1
8	M6X50H	6mm x 50mm Flanged Hex Head Bolt	1
9	M6X35H	6mm x 35mm Flanged Hex Head Bolt	1
10	RACE-SPS-1	Medium Exhaust Spring	2
**	INS-14-K	AMA 94 dB Sound Insert (Installed)	1
**	INS-2M28-K	2M-MAX Sound Insert Kit	1
**	347PLUG	Muffler Wash Plug	1
**	ST-200	Spring Puller Tool	1
**	17029	Yoshimura Sticker Sheet	1
<i>Optional Replacement Parts</i>			
REPACK-RS4-PK11		Re-pack Kit	
SA-04-K		Spark Arrestor Kit	

-TOOLS REQUIRED-

Metric Socket Set • Combination Wrench Set • Torque Wrench • Metric Allen Wrench Set

-REMOVAL-

1. *Removing the muffler.*

- a) **Follow owner's manual instructions to remove stock muffler assembly.**
- b) **Remove stock header from bike by removing the stock springs securing header to header flange.**

NOTE: Stock header flange springs will be reused on the Yoshimura exhaust system.

-INSTALLATION-

1. *Small parts installation.*

- a) **Install provided rubber grommets into muffler bracket.**
- b) **Install aluminum spacers into rubber grommet. See diagram for proper orientation.**

NOTE: Thicker spacer goes to rear muffler mount.

- c) **Remove the stock washers and grommet from the stock header and install onto Yoshimura tailpipe.**

2. *Installing Yoshimura Full-System Exhaust.*

- a) **Remove spring and tailpipe from muffler.**
- b) **Install Yoshimura tailpipe onto Yoshimura header and secure to frame mount using stock hardware. Orientation is as follows: Stock bolt, stock washer, stock grommet, stock washer, and stock metal u-nut. Do not torque bolt or install springs at this time.**
- c) **Install muffler onto Yoshimura tailpipe and secure using supplied hardware. Do not tighten bolts or install springs at this time. See diagram for proper orientation and order of hardware.**
- d) **Torque muffler mounts to 7.4 ft-lb (10Nm, 1.0kg-m).**
- e) **Torque tailpipe mount to 18.5 ft-lb (25Nm, 2.5kg-m).**
- f) **Install stock springs between header and flange, and supplied Yoshimura springs between header, tailpipe, and muffler.**

3. *Fitment check and Notes.*

- a) **Before starting motorcycle, check for proper clearance between new exhaust system and rear suspension (i.e. tire, swing-arm, brake, rear shock, engine, and etc.) If any problem is found, please carefully follow through the installation steps again.**
- b) **It is recommended that the muffler and tailpipe be wiped down with rubbing alcohol to remove oil and fingerprints. This will help prevent tarnishing of the finish after the exhaust is heated up.**
- c) **NOTE: After starting motorcycle, it is normal for new exhaust system and muffler to emit smoke until oil residue burns off.**

Find out more about exhaust parts we have.