



# YOSHIMURA

RESEARCH & DEVELOPMENT OF AMERICA, INC.

5420 DANIELS STREET STE A, CHINO CA. 91786 · (800)634-9166 · (909)628-4722 · FACSIMILE (909)591-2198

[www.yoshimura-rd.com](http://www.yoshimura-rd.com)

## TRS TRI-OVAL PERFORMANCE EXHAUST SYSTEM

### HONDA

### '02-07

**123026 (2,5,7)** STAINLESS STEEL RACE SLIP-ON SYSTEM

### CB919 HORNET

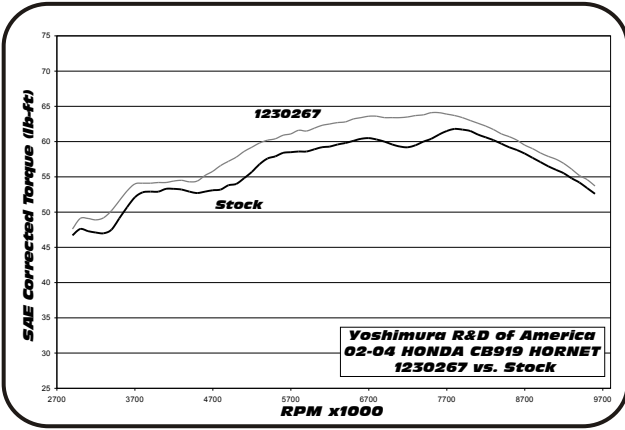
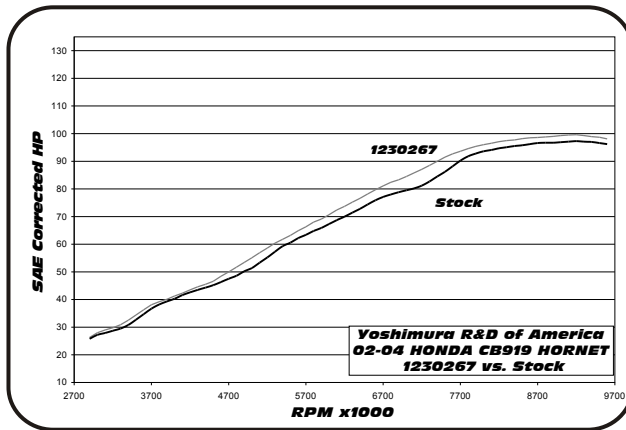

Note: Dyno graphs are for comparison use only. Actual results may vary depending on operating and motorcycle condition.



**THIS PRODUCT IS DESIGNED FOR USE IN CLOSED COURSE RACING AND IS NOT INTENDED FOR HIGHWAY USE.**



NOTE: IN THE STATE OF CALIFORNIA, IT IS ILLEGAL TO MODIFY THE EMISSION CONTROL SYSTEM. WHICH INCLUDES THE CARBURETORS OF ANY VEHICLE.

**Caution:** Exhaust system can be extremely hot. Let motorcycle cool down before beginning installation.

**Note:** Read through all instructions before beginning installation.

## Tools Needed:

10mm and 12mm sockets  
3/8" ratchet and extension  
5mm and 6mm Allen wrench  
Torque wrench  
13/64" Drill bit  
Electric Drill  
Safety Glasses

## Installation Steps:

- 1 Remove seat.
- 2 Remove rear tail section: Remove plastic caps from 4 grab rail bolts, unbolt grab rail. Remove rubber caps from 2 tail mounting bolts, unbolt tail. Remove 2 plastic retaining pins from front of tail. Slide tail partially toward rear. Disconnect 2 taillight connectors, located inside to rear. Remove tail section. (See Fig. 1)
- 3 Remove stock heatshield from stock mufflers: Remove allen head cap screw and slide heat shield toward front of bike. (See Fig. 1) Make sure mounting tab heat insulators are installed inside heat shield retaining straps.
- 4 Unbolt and remove stock mufflers with tailpipes. (See Fig. 2)
- 5 Install supplied muffler clamp heat insulators into muffler clamps. Slide muffler clamps over mufflers. (See Fig. 3 for correct orientation)
- 6 Slip collector clamp over inlet of Yoshimura slip on. Slide slip-ons onto stock pipes. (Note: this system does not use stock midpipe gaskets)
- 7 Mount muffler clamp to stock mounting position using supplied bolts and spacers. Do not torque bolts at this time. (See Fig. 3)

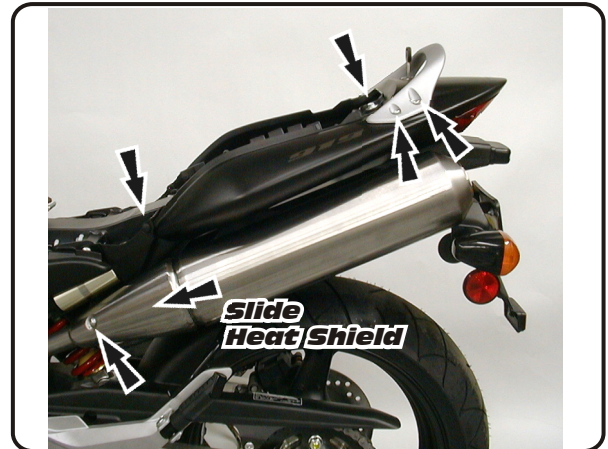

Fig. 1

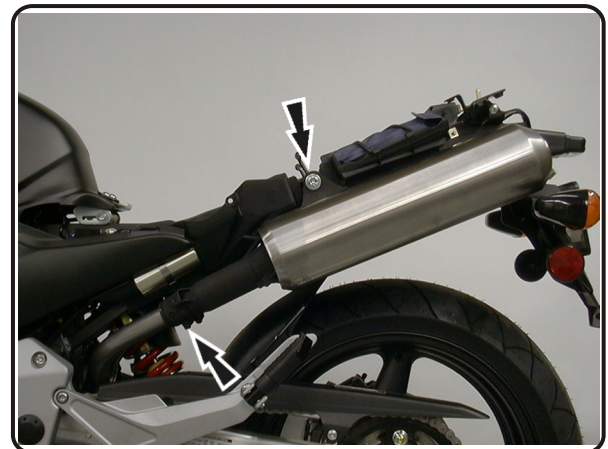

Fig. 2

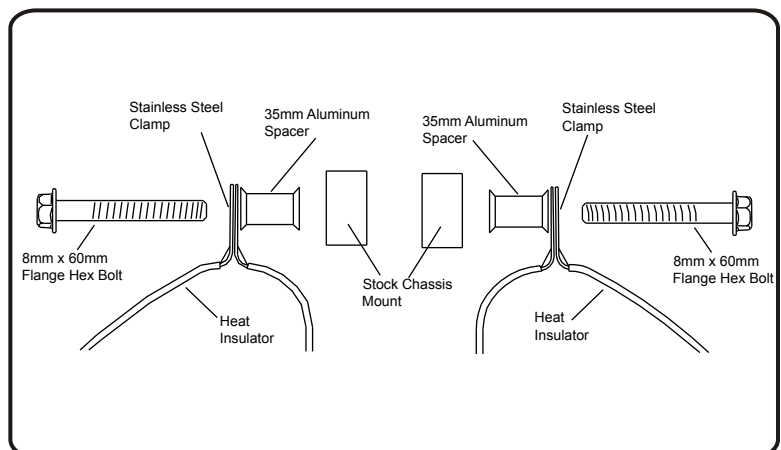
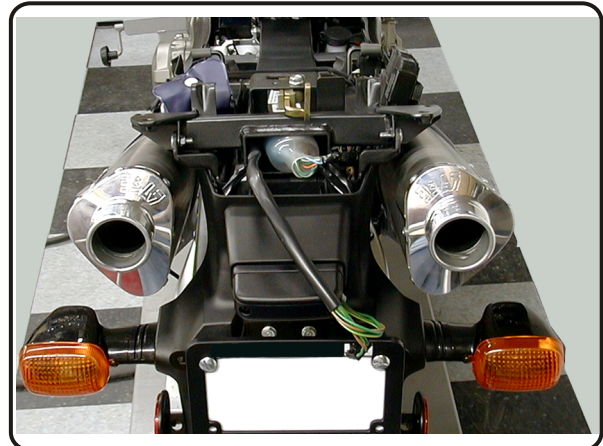

Fig. 3

- 8 Check muffler position to ensure it is the same from right to left. In some cases the muffler will have to be held and the tailpipe twisted to adjust alignment. Check the heat shield mounting bosses from side to side to make sure they are at the same level. Finally check the mufflers from the rear to ensure they are correctly positioned (See fig4.)
- 9 Torque muffler clamp bolts to 2.3 kg-m (16.5 lb-ft).
- 10 Using electric drill and 13/64" drill bit drill hole in stock pipe in center of hole on Yoshimura slip on. Install S-rivet, slide collector clamp over rivet. Torque collector clamp to 2.5 kg-m (18 lb-ft)
- 11 Re-install stock heat shields, making sure stock insulators are in place on heatshield.
- 12 Re-install tail section. **NOTE:** When installing tail section make sure that seat lock release latch on tail section is in **FRONT** of release handle on bike (See Fig.5)
- 13 It is recommended that the entire exhaust system be wiped down with rubbing alcohol to remove oil and fingerprints. This will help prevent tarnishing of the finish after the exhaust is heated up.
- 14 Before starting motorcycle, check for proper clearance between new exhaust system and motorcycle. (i.e. Bodywork, swing-arm, etc.) If any problem is found, please carefully follow through the installation steps again. If problem still persists, please call Yoshimura tech. dept. at (800)634-9166 / in CA (909)628-4722

**Note:** After starting motorcycle, it is normal for new exhaust system to smoke until oil residue burns off.

**Fig. 4****Fig. 5**



**#123026(2,5,7)**

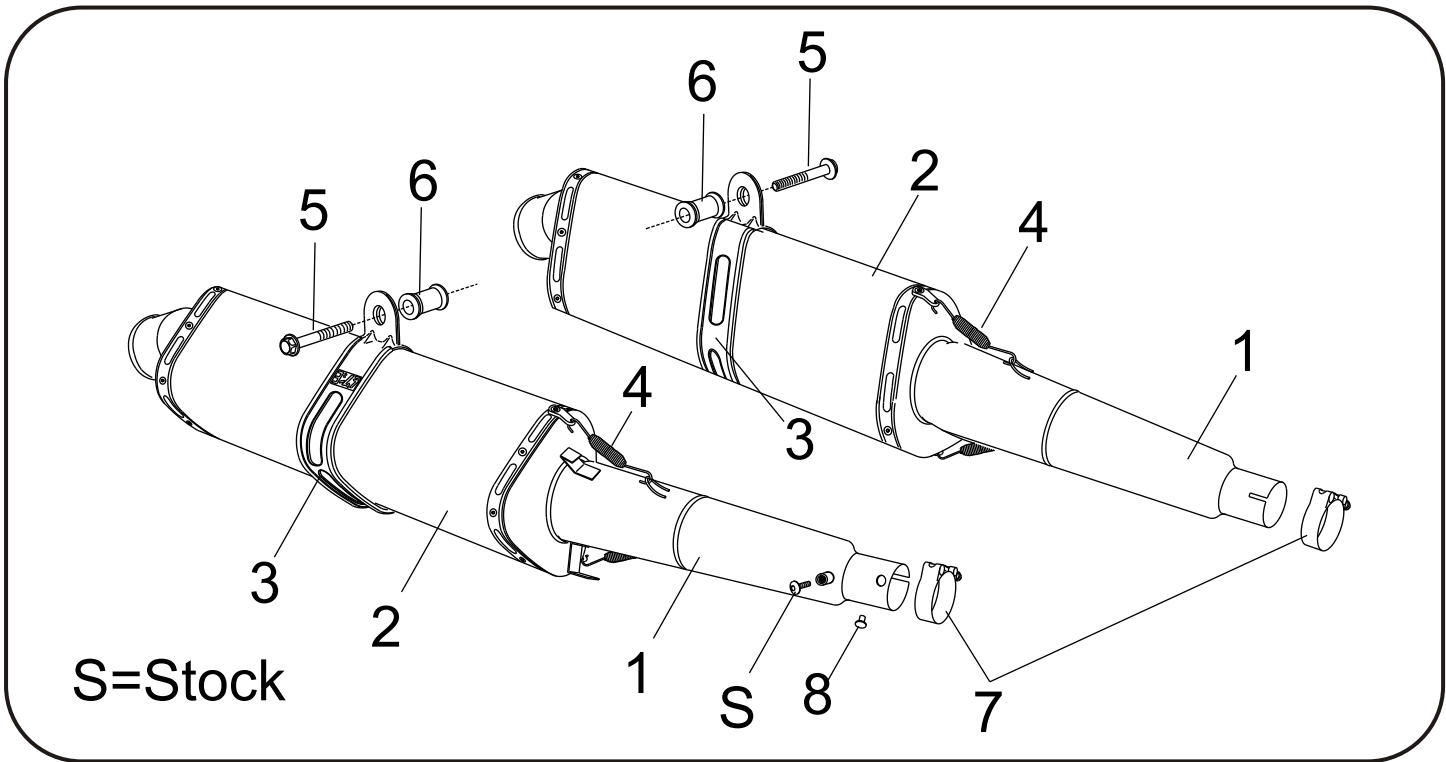

Parts Diagram

NO.	DESCRIPTION	QTY	PART #
1	Yoshimura Tail Pipe Stainless Steel (Left Side)	1	1230-430
	Stainless Steel (Right Side)	1	1230-431
2	TRS Mufflers	2	**
3	Stainless Steel Muffler Clamp Stainless Steel or Titanium Sleeve use Carbon Fiber Sleeve use	2	CTS088X CTS088
4	2.5" Exhaust Spring	4	RACE-SPS
5	8mm X60mm Hex Head Bolt	2	M8X60H
6	35mm Aluminum Spacer	2	8X35SPCR
7	Stainless Steel Collector Clamp	2	220-55
8	Collector Rivet	2	S-RIVET
**	Muffler Clamp Heat Insulator	2	HT SHLDTRS
**	Spring Puller Tool	1	ST-200
**	Yoshimura Vinyl Sticker	1	17029

**Nuts and Bolts Guide (Actual Size):**

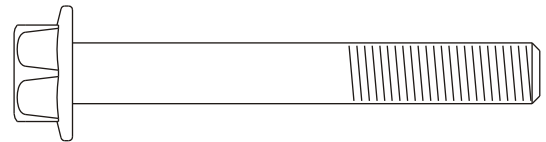

8mm x 60mm  
Flange Hex Bolt