

2002-2003 HONDA CIVIC SI I-4 2.0L, HATCHBACK

Warning: When working on under or around any vehicle exercise caution. Please allow the vehicle's exhaust system to cool before removal, as exhaust system temperatures may cause severe burns. If working without a lift, always consult vehicle manual for correct lifting specifications. Always wear safety glasses and ensure safe work area. Serious injury or death could occur if safety measures are not followed.

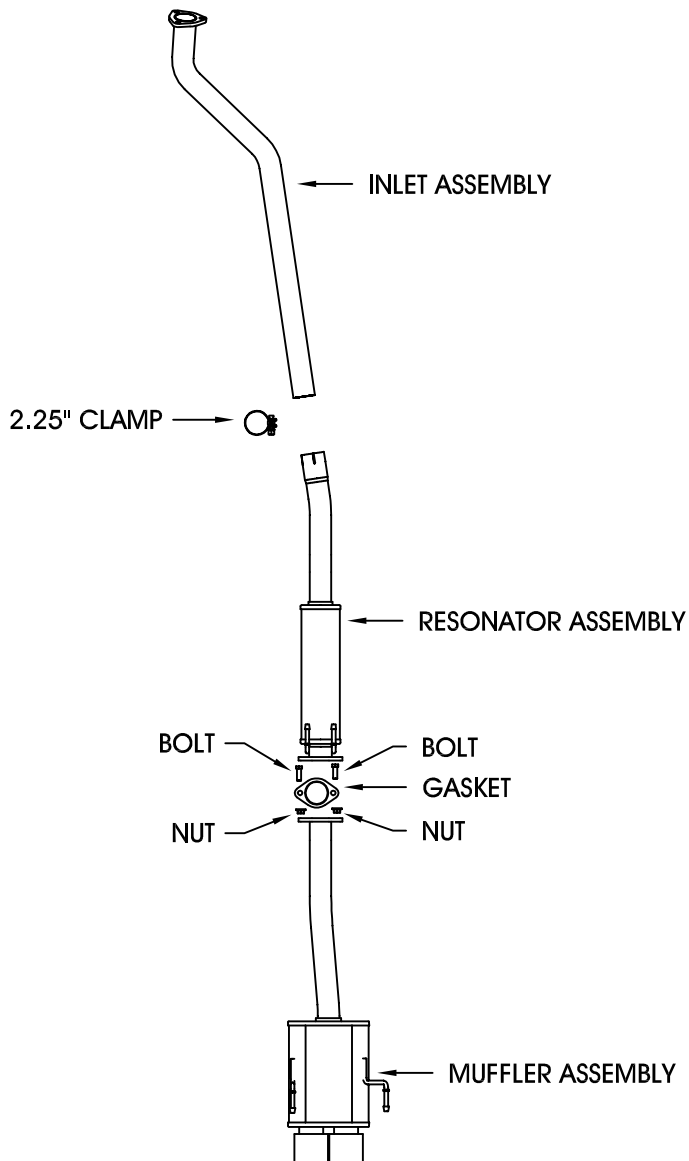

Step 1: (Carefully read all instructions before installation) Unbolt the OEM muffler from the extension pipe in front of the rear control arm. Remove the muffler from the OEM rubber insulators. Do not damage the rubber insulators, as they will be reused on your new system. Unbolt the extension pipe from the catalytic converter, and remove it from the OEM rubber insulators. Do not discard the front extension pipe fasteners, as they will be reused.

Step 2: To mount the new system, starting at the catalytic converter, install the inlet assembly with the OEM fasteners. (Leave all components loose for final adjustment). Install the resonator assembly into the OEM rubber insulators, and attach to inlet assembly with clamp as shown. Install the muffler assembly in the OEM rubber insulators and bolt it to the resonator assembly with supplied fasteners and gasket.

Step 3: With all components mounted loosely, adjust the system for overall aesthetics and clearance of frame & bodywork. (MAGNAFLOW recommends at least 1/2" of clearance between the exhaust system and any body panels to prevent heat-related body damage or fire.)

Step 4: Once a final position has been chosen for the new system, evenly tighten all fasteners from front to rear. Inspect all fasteners after 25-50 miles of operation and retighten if necessary.

*MAGNAFLOW Performance Exhaust recommends professional installation on all their products

Technical support: 1-800-959-9226 ext. 4500

MAGNAFLOW Performance Exhaust - 22961 Arroyo Vista - Rancho Santa Margarita, CA 92688