

### 2001 HONDA CIVIC DX/LX/EX - I-4

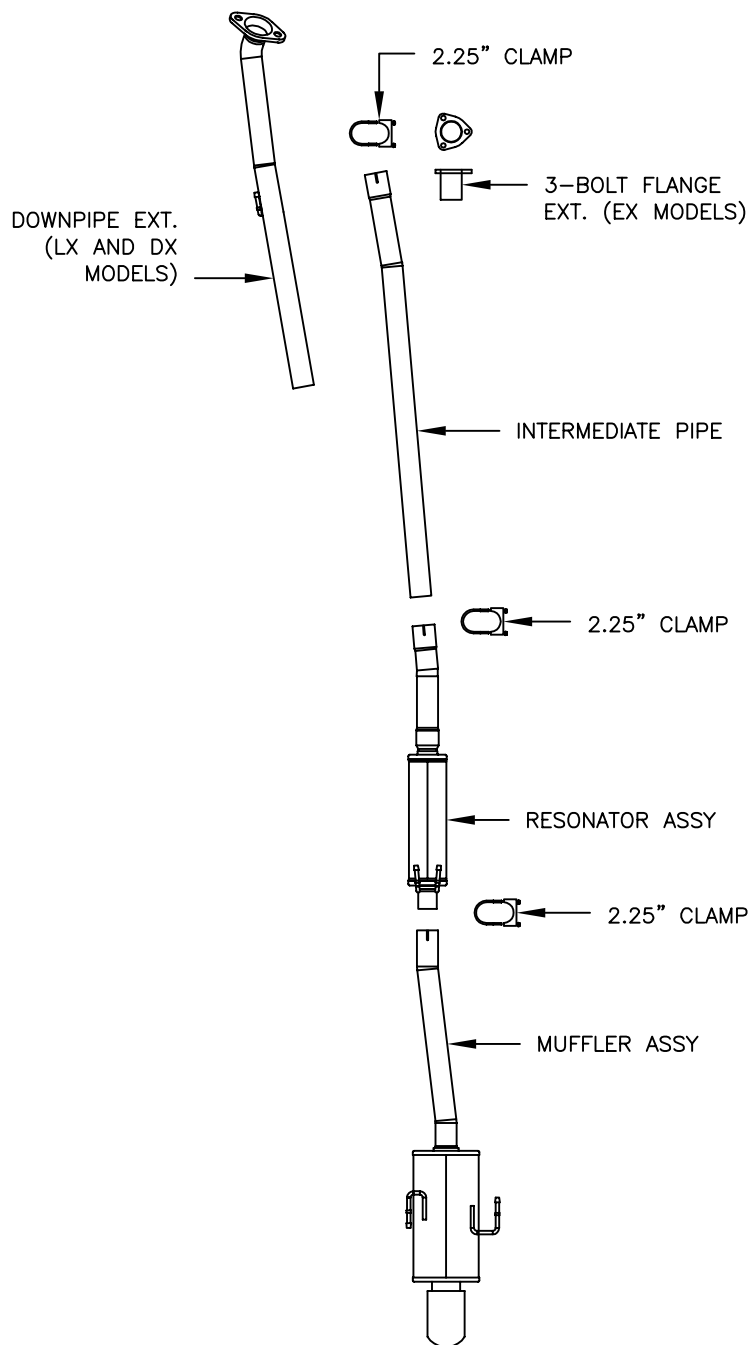

**Warning:** When working on under or around any vehicle exercise caution. Please allow the vehicle's exhaust system to cool before removal, as exhaust system temperatures may cause severe burns. If working without a lift, always consult vehicle manual for correct lifting specifications. Always wear safety glasses and ensure safe work area. Serious injury or death could occur if safety measures are not followed.

**Step 1:** (Carefully read all instructions before installation) Unbolt the OEM muffler from the extension pipe in front of the rear control arm. Remove the muffler from the OEM rubber insulators. Do not damage the rubber insulators, as they will be re-used to mount the new system. Unbolt the front extension pipe from the catalytic converter. LX and DX models converter is located on the exhaust manifold. Do not discard the spring/stud assemblies, as they will be re-used to mount the new system. EX models converter is located under the car.

**Step 2:** If you have an LX or DX model, install the downpipe extension to the exhaust manifold, re-using the OEM fasteners. If you have an EX model, install the 3-bolt flange extension to the converter re-using the OEM fasteners. Leave ALL fasteners loose for final adjustment of the complete system. Working rearward on all models, install the intermediate pipe using a supplied 2.25" clamp. Slip-fit the resonator assembly to the intermediate pipe using a supplied 2.25" clamp, and fit the welded hangers into the OEM rubber insulators. Slip fit the muffler assembly to the resonator assembly using a supplied 2.25" clamp, and fit the welded hangers into the OEM rubber insulators.

**Step 3:** With all components still mounted loosely, adjust the system for overall aesthetics and clearance of frame & bodywork. (MAGNAFLOW recommends at least 1/2" of clearance between the exhaust system and any body panels to prevent heat-related body damage or fire.)

**Step 4:** Once a final position has been chosen for the new system, evenly tighten all fasteners from front to rear. Inspect all fasteners after 25-50 miles of operation and retighten if necessary.

\*MAGNAFLOW Performance Exhaust recommends professional installation on all their products

Technical support: 1-800-959-9226 ext. 4500