

# AMP RESEARCH Power Step

MADE IN USA

## RUNNING BOARD TRIM STRIP

Requires New Twin Rib Extrusion

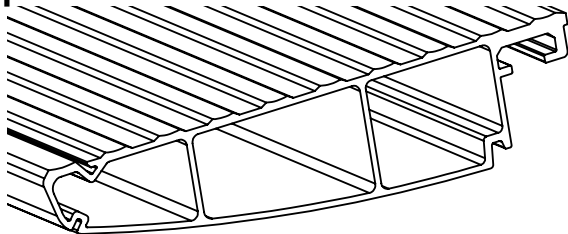

Trim Strip Part #

10-75149-90

10-75150-90

Board Length

79"

85"

### INSTALLATION TIME



1:00 hr

### SKILL LEVEL



2= Moderate

### TOOLS REQUIRED

- Safety glasses
- 3/16 Allen
- Saw (some Applications)

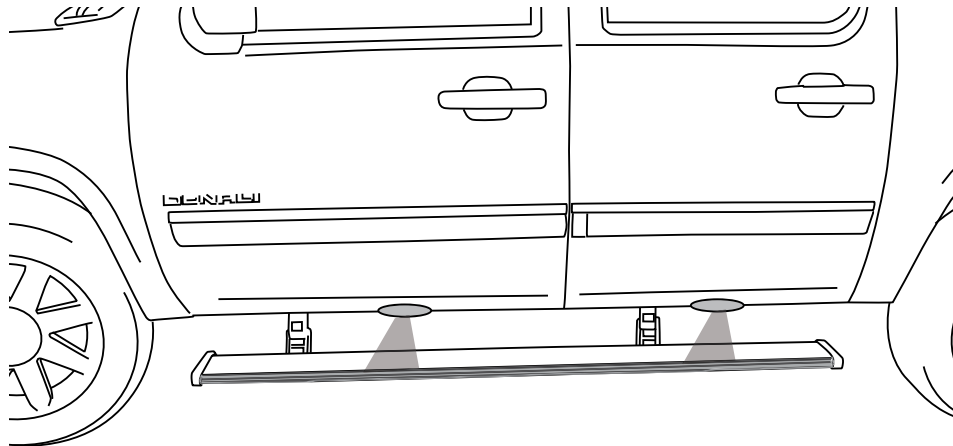

TECH SUPPORT 1-888-983-2204 (Press 2) Monday - Friday, 6:00 AM - 5:00 PM PST

Designed and manufactured by AMP Research. Patent 6,830,257 / 6,641,158 / 6,834,875 / 6,938,909 / 6,942,233 / 7,007,961 Other US and worldwide patents pending. 5-year limited warranty. Professional installation is recommended.

1 x2

10-75149-90 (79" Board)  
10-75150-90 (85" Board)  
Trim Strip

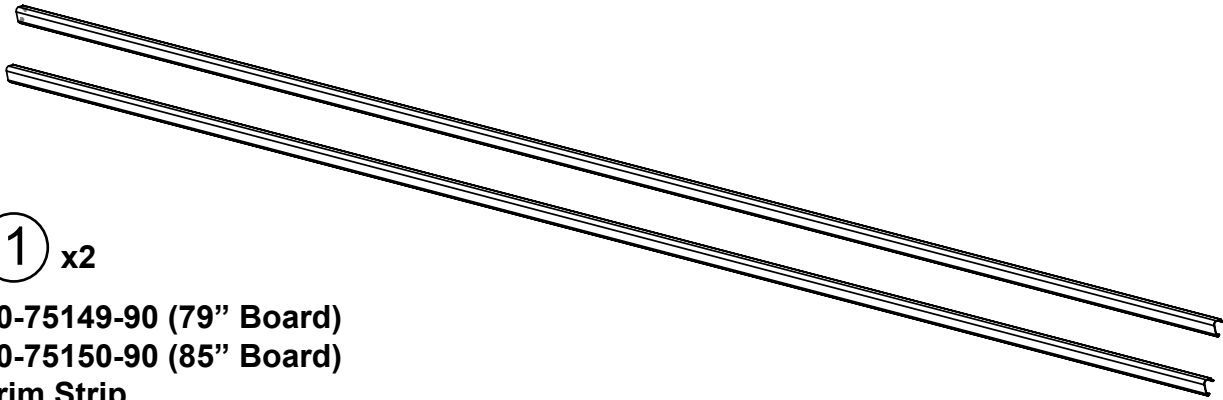

Using a 3/16" Allen head loosen screw on end cap.

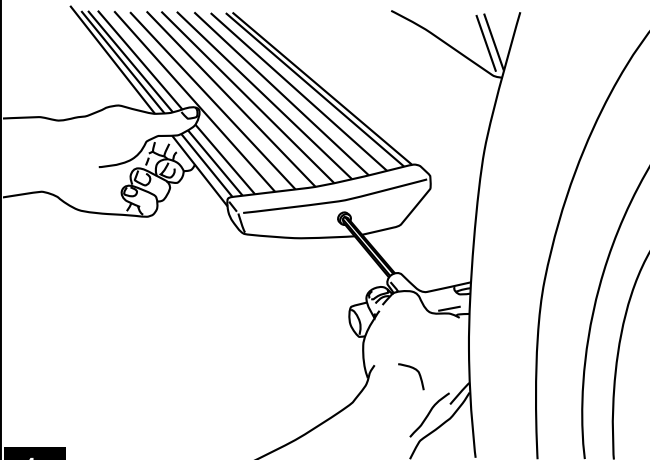

1

Remove end cap.

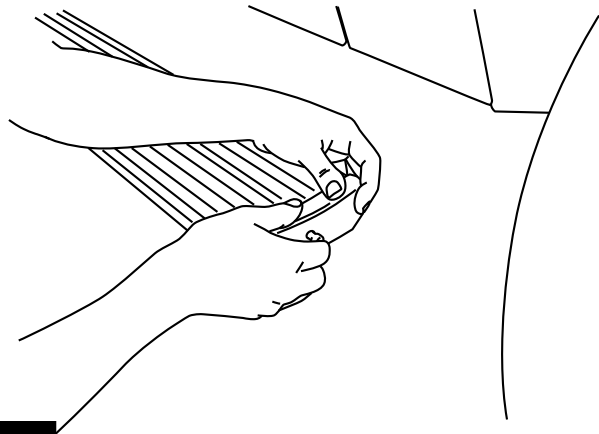

2

Peel off protective film on Trim Strip.

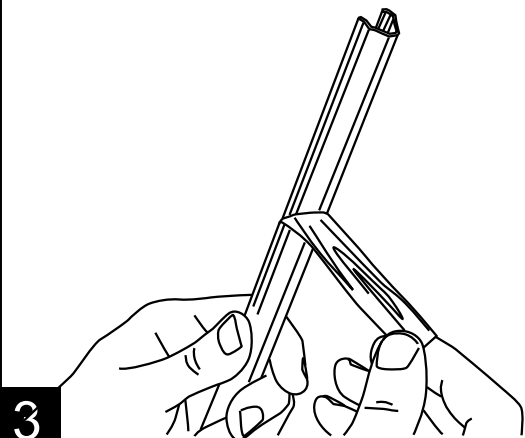

3

Line Trim Strip to the groove on the Running Board Extrusion. See Step 5 for proper Trim Strip engagement. **Caution: Trim Strip edges can be sharp.**

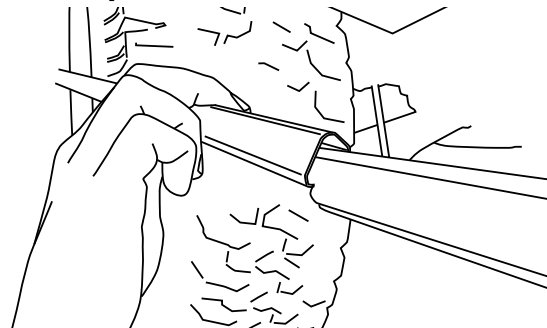

4

**NOTE: Wheels may need to be adjusted to allow for clearance during install.**

**NOTE: Trim Strip should be lined up in both the upper and lower grooves.**

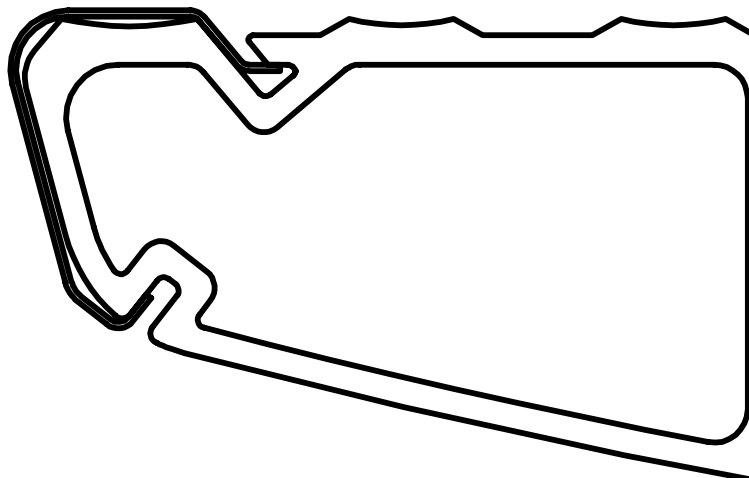

**5**

With Trim Strip lined up to the groove slide it onto Running Board and under the cap on the opposite end. **Ensure that the Trim Strip does not buckle during install.**  
**Caution: Trim Strip edges can be sharp.**

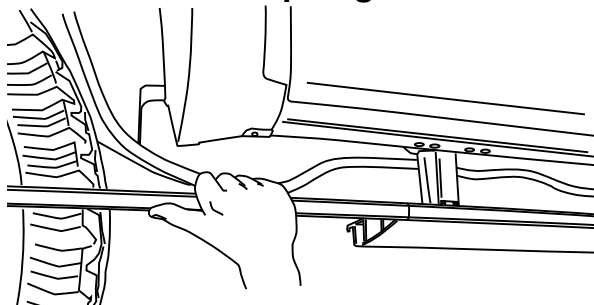

**6** Once Trim Strip is installed verify that it is properly engaged along the Running Board.

If End Cap wedge was completely removed reinstall onto End Cap.

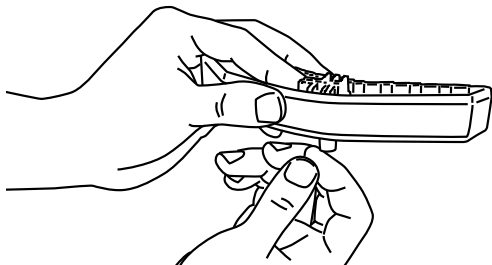

**Wedge Orientation**

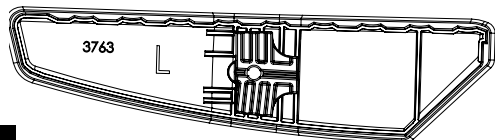

Note: Left and Right End Caps have matching Wedges.

**8**

Cutting may be required if your Running Board is less than 79". Excess material can be trimmed with a Hacksaw.

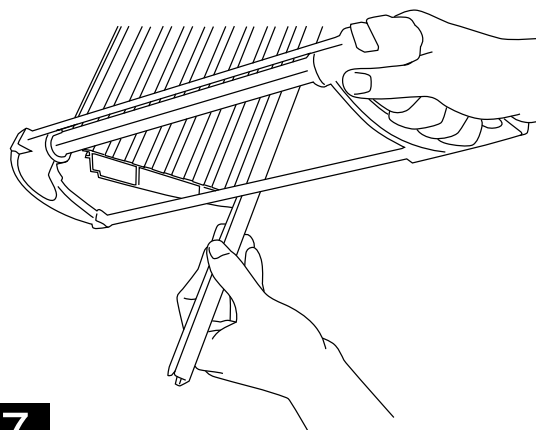

**7**

Slide End Cap onto board.

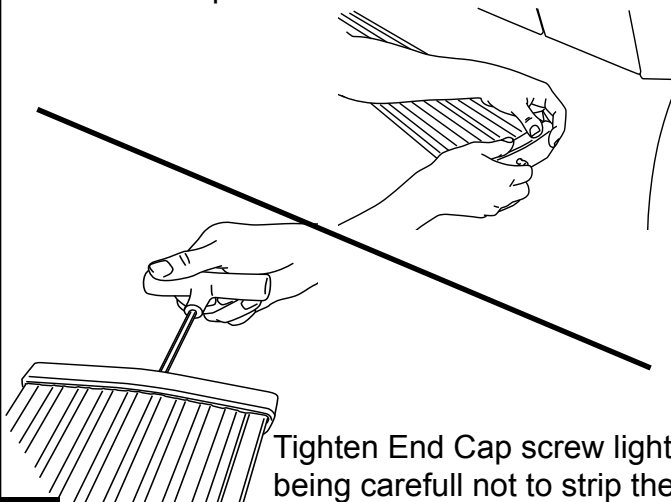

Tighten End Cap screw lightly being carefull not to strip the End Cap Wedge.

**9**