

INSTALLATION SHEET-Explorer Sport Trac

CLASSIC
PLATINUM & BLACKMAX™

extang
AMERICA'S BEST
SELLING TONNEAUS

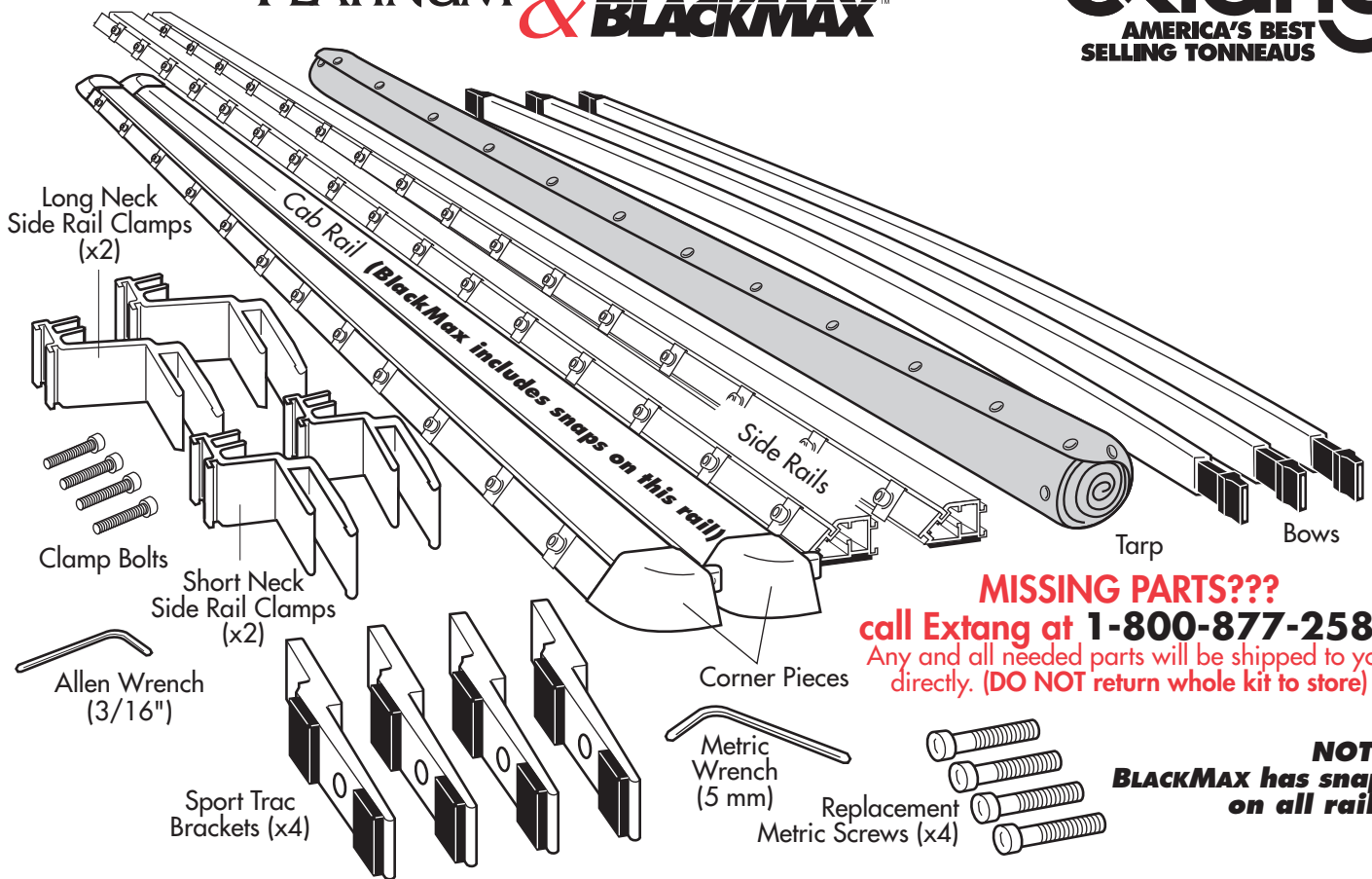

MISSING PARTS???
call Extang at **1-800-877-2588**
Any and all needed parts will be shipped to you directly. (DO NOT return whole kit to store)

NOTE:
BLACKMAX has snaps on all rails.

PARTS INCLUDED IN YOUR KIT. You may want to lay them out in this manner for accessibility.

1



Wash truck bed.

2



Remove paper tape from all rails. Discard properly.

3

For Classic Platinum Only (This step does not apply to BlackMax)

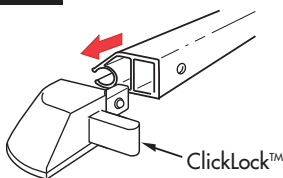

Pull back on the ClickLock™ release and remove one corner from cab rail.

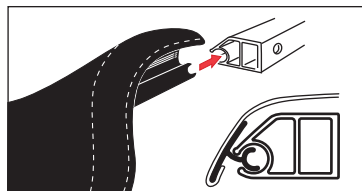

Feed tarp dowel into cab rail. (NOTE: For easiest feeding action, place tarp on a flat smooth surface, and keep dowel straight while feeding into cab rail. Caution, pavement may scuff tarp.)

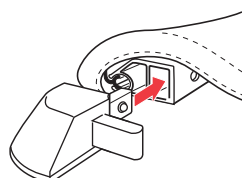

Reinsert corner piece into cab rail until it "clicks" and locks into place.

4

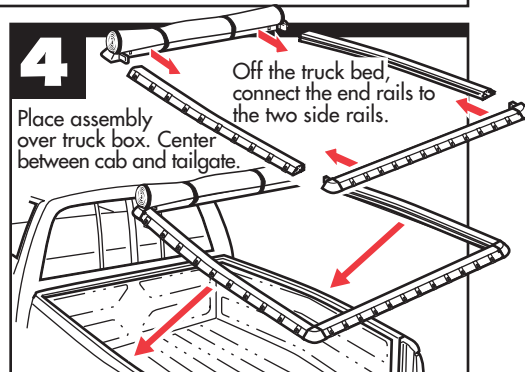

Extang Corporation
1901 E. Ellsworth Rd.
Ann Arbor, MI 48108
734 677-0444, Fax: 734 677-8409

Register your warranty at:
www.extang.com

Item No. 0025-0708 RH Printed in U.S.A.

5

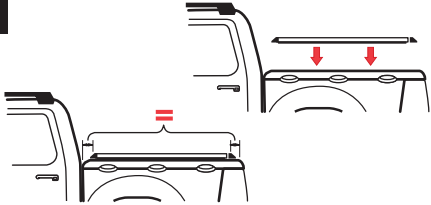

Place the rail assembly over the side of the truck box. Center rails evenly between cab and tailgate.

6

Side Rail Clamping (Same for each side)

Remove two hex socket screws from the inside of the Sport Trac payload bed. Place Sport Trac Bracket over screw hole and replace with provided metric screws and secure firmly into bed wall with metric wrench.

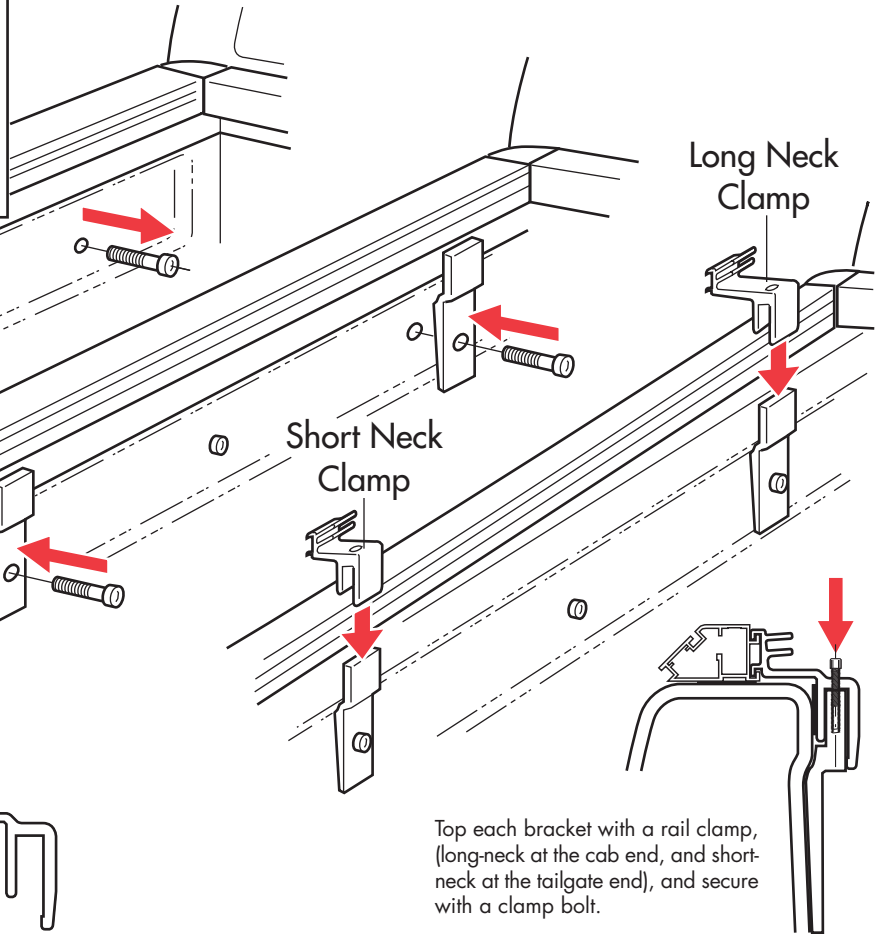

Note: Insert side rail clamp all the way into rail.

Top each bracket with a rail clamp, (long-neck at the cab end, and short-neck at the tailgate end), and secure with a clamp bolt.

7

Insert bow onto top or bottom peg.
(Top peg for performance, Bottom for good looks.)

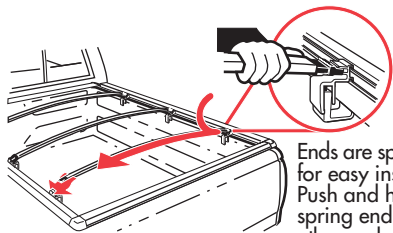

Ends are spring loaded for easy installation. Push and hold on spring end and let the other end slide on with the spring action.

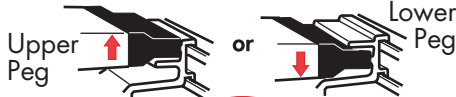

SPECIAL FEATURE: Two pegs offer two height adjustments.

Note: Bow End does not fit between pegs.

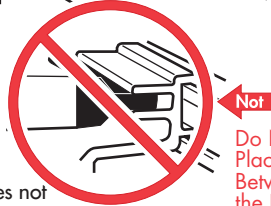

Do Not Place Between the Pegs

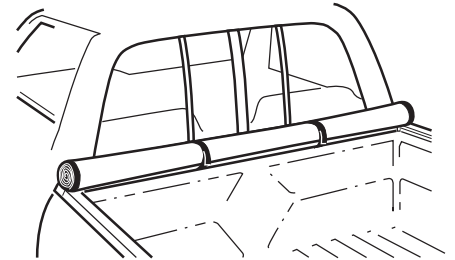

EASY USE OF TRUCK BED

Tarp may be rolled up and secured with Velcro® for bulk hauling

8

Start at Corners

Attach tarp by starting at the corners, and snap in place.

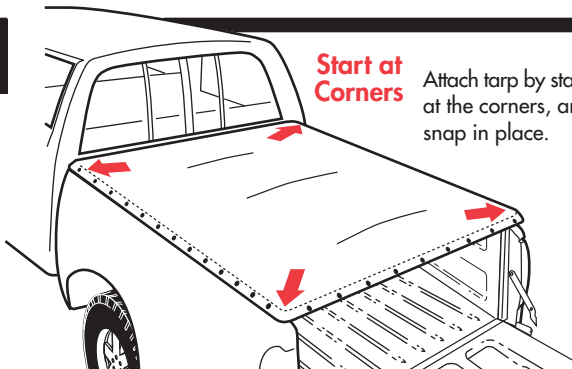

SPECIAL FEATURE Weather-adjustable Snaps

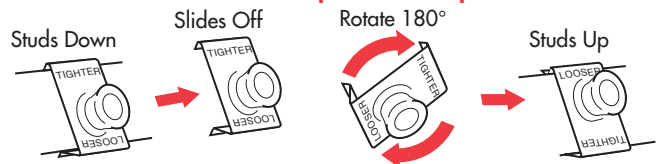

SUMMER SETTING
Takes up slack in tarp caused by warm weather.

WINTER SETTING
Allows more slack in tarp for cold temperatures.