



ATV WP2 FRONT MOUNT KIT

For CAN-AM ATVs

ASSEMBLY / OWNER'S MANUAL

Part No: 16-7010

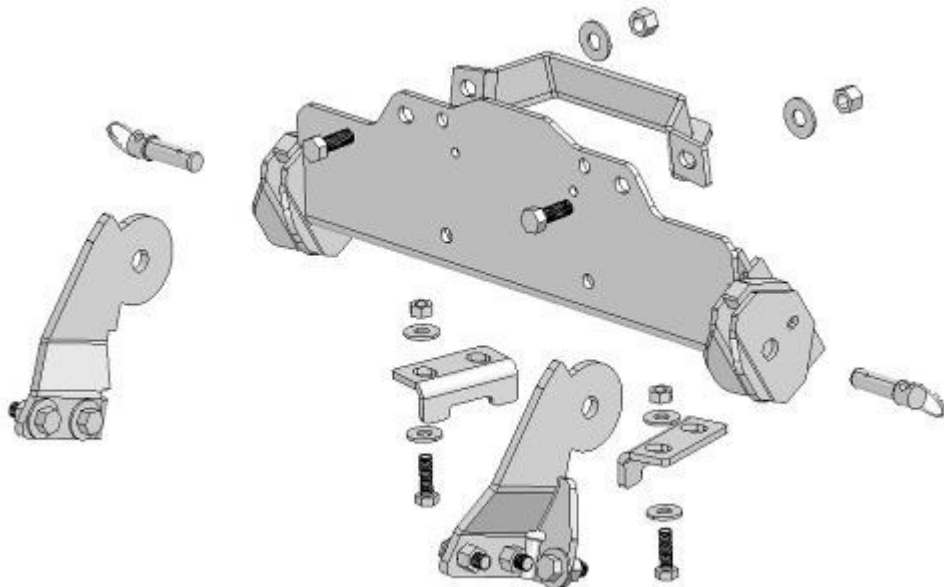

OPERATING INSTRUCTIONS

Congratulations! You've just purchased the most durable plow component in the industry. Cycle Country plow components work great for summer or winter plowing. With proper care and maintenance, your Cycle Country plow system will last for years to come!

NOTICE
ATV WP2 Plow systems require additional components for operation*
Cycle Country Plow Blade
Cycle Country WP2 Push Tube Kit
Cycle Country Lift System (Winch Kit, Electric Lift)
<small>* WP2 Front Mount Kits are vehicle-specific. To find your specific application, use the 'Search by Vehicle' function at www.cyclecountry.com</small>

Please read and understand all assembly instructions, notices and warnings before assembling and operating your Cycle Country plow system.

Follow these guidelines to ensure satisfactory operation:

- Periodically check for wear and tightness of all fasteners. Replace or re-torque fasteners as necessary.
- Read this manual and your ATV operators manual before use.
- Before first use, set plow in the furthest right or left angled position to check for interference with the vehicle.
- Operate with extreme caution on slopes and rough terrain. Be familiar with the area before you plow.
- Be aware of immovable objects that could be hidden in the dirt, gravel or snow you are plowing.
- To avoid damage when plowing dirt, gravel or snow into a pile, reverse direction before raising the plow blade.
- Do not ram the plow into piles of dirt, gravel or snow, as damage to the plow system or vehicle may result.

A complete operator's guide can be downloaded for free at www.cyclecountry.com. This guide contains beginner-to-advanced information regarding plow systems and operation.

SAFETY INFORMATION

Cycle Country plow systems were designed with your safety in mind. In order to protect you and your vehicle, certain parts of the plow system and/or hardware are designed to fail when the equipment is over-stressed.

 WARNING
To avoid personal injury or damage to your vehicle:
Do not exceed 5 mph (8 kph) with the blade installed
Be aware that vehicle ground clearance is reduced with plow system installed
Keep yourself, other people and pets away from the blade and moving parts during operation
Before adjusting blade angle or disconnecting the plow system, stop the engine and set the parking brake
Remove your plow system before trail riding
Do not ram the plow system into piles of dirt, gravel or snow

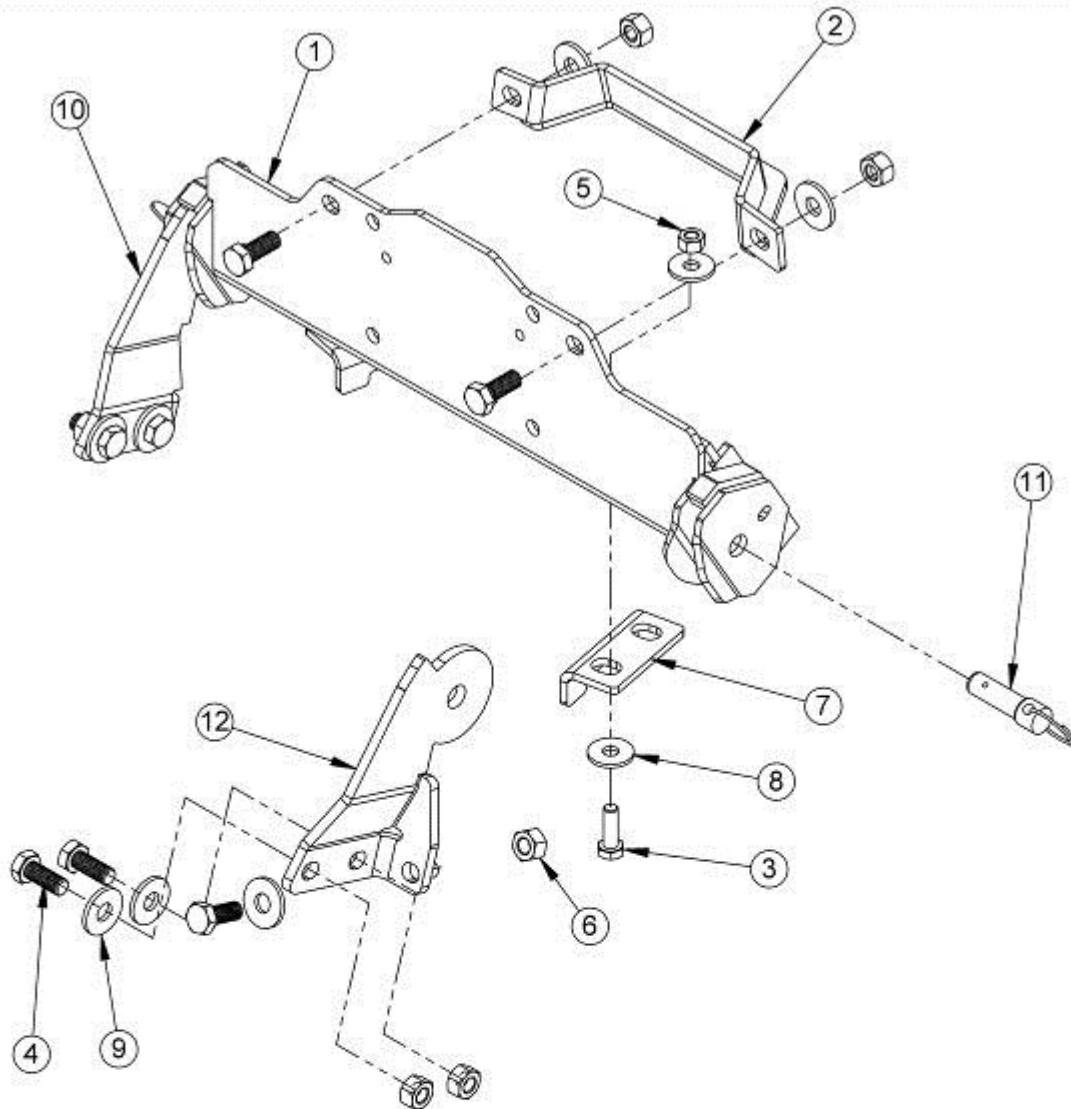

Model Number 16-7010 Parts List

ITEM NO.	QTY.	PART NO.	DESCRIPTION
1	1	CYC6004	Winch Mount Weldment
2	1	CYC6008	Back Bracket Weldment
3	2	PUR3012	Metric Bolt M8 x 25mm
4	8	PUR3023	Metric Bolt M10 x 25mm
5	2	PUR3068	Nylon Lock Nut M8
6	8	PUR3069	Nylon Lock Nut M10
7	2	CYC6013	Bracket
8	4	PUR3087	Flat Washer 8mm
9	8	PUR3088	Flat Washer 10mm
10	1	CYC6011	Bracket Right
11	2	PUR2497	Quick Release Pin 1 x .5
12	1	CYC6012	Bracket Left

Hardware Package CYC6014

PARTS ORDERING INFORMATION:

Replacement fasteners are common-type
and can be purchased locally. Use minimum class 8.8 zinc-coated fasteners.

BEFORE YOU BEGIN:

- Please read and understand all instructions.
- Verify all parts and tools are accounted for.
- To ensure a satisfactory installation, follow all steps correctly and in the sequence described.
- All directions referring to right and left are when the rider is sitting on the machine

TOOLS REQUIRED:

- Basic Hand Wrench and Socket Set
- Torque Wrench

INSTALLATION NOTES:

NOTICE

16-7010 is not compatible with other winch mounts.
Any currently installed winch and mount must be removed prior.

NOTICE

16-7010 provides a location to attach a 4-bolt Cycle Country Winch, compatible aftermarket winch or Electric Lift Relay.
Install only on Cycle Country 16-7010.

NOTICE

Certain CAN-AM models may have extra guards and/or shrouds that need to be removed before installation.

INSTALLATION OF FRONT MOUNT:

1. Remove the bumper, skid plate, and any previously installed winch equipment from front of the ATV.
2. Remove the front plastic bumper and any additional shrouds that may be covering the front frame area.
3. Remove the OEM fasteners attaching the aluminum bumper mount to the ATV frame.
4. Remove any existing winch mount and winch from the ATV (if equipped).

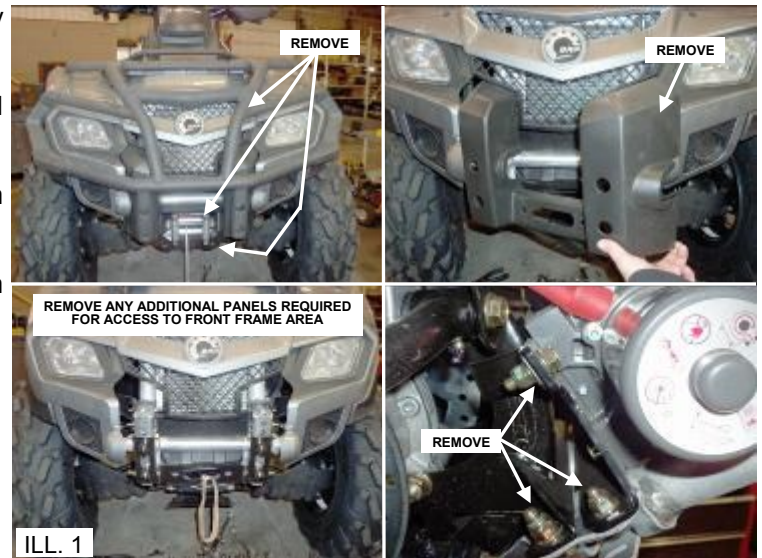

5. Install the winch (or electric lift relay) to the plow mount weldment, Item #1, using fasteners supplied with the winch (or electric lift relay). See Illustration 2.

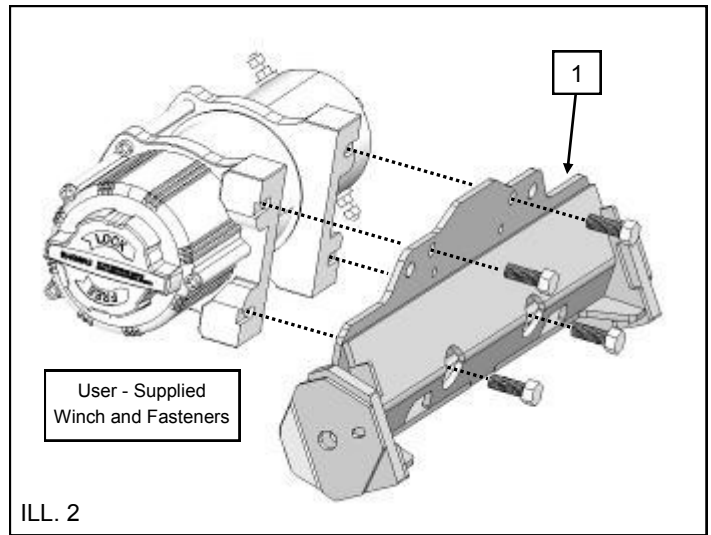

6. Position Back Bracket Weldment, Item #2 behind the ATV frame downtube and align it with the plow mount.

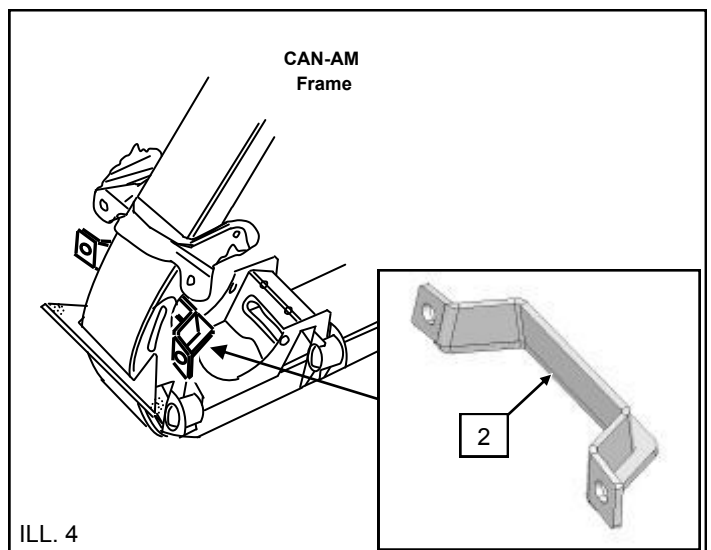

7. Place the assembled plow mount weldment, Item #1, into the ATV frame opening and align the weldment mounting holes with the upper bumper mounting holes.

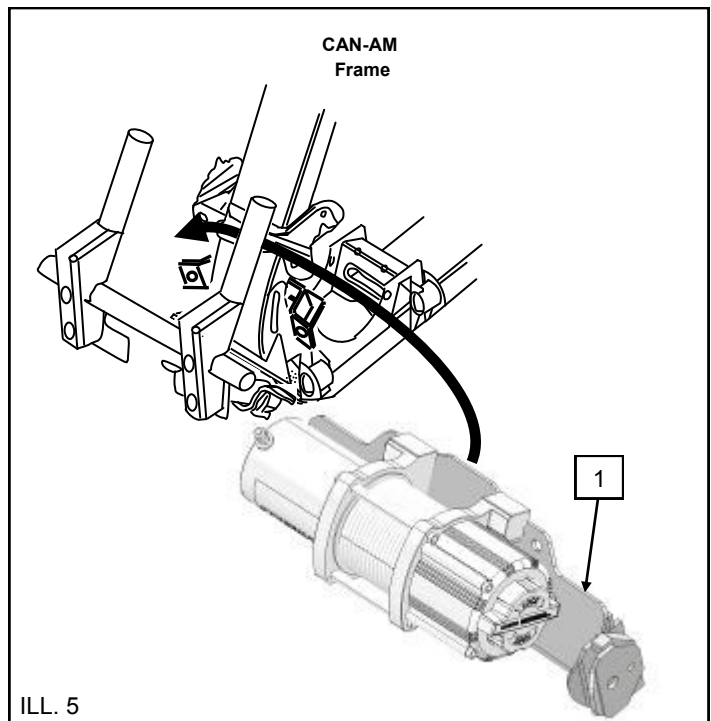

- Place washers, Item #8, over the bracket holes and fasten the weldments together with bolts, Item #3 and lock nuts, Item #5. *Do not torque fasteners at this time.*

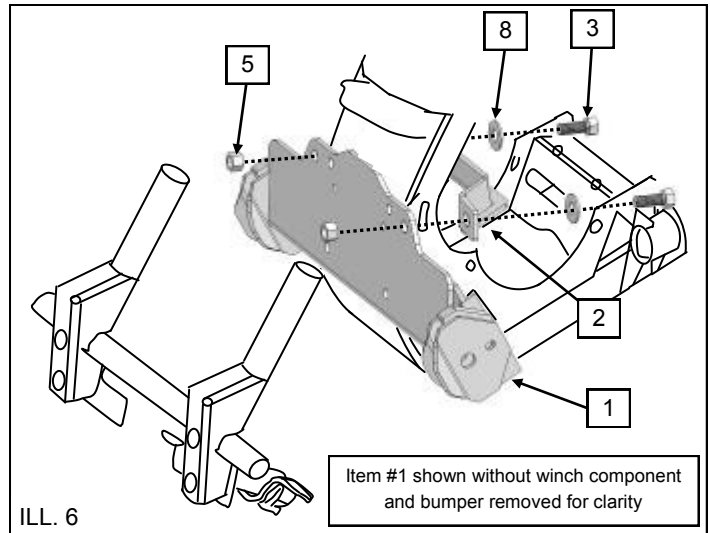

- Position Lower Brackets, Item #7 at the bottom of the frame/bumper mounting holes. Place washers, Item #8 over the upper slotted holes only. Fasten the brackets and plow mount using bolts, Item #3 and lock nuts, Item #5. *Do not torque fasteners at this time.*
- Reinstall the OEM bolts and lock nuts. See Illustration 7.
- Once all the components are properly aligned, torque all fasteners to specification.

 = T
FASTENER TORQUE: 17 ft. lbs. (23 Nm)

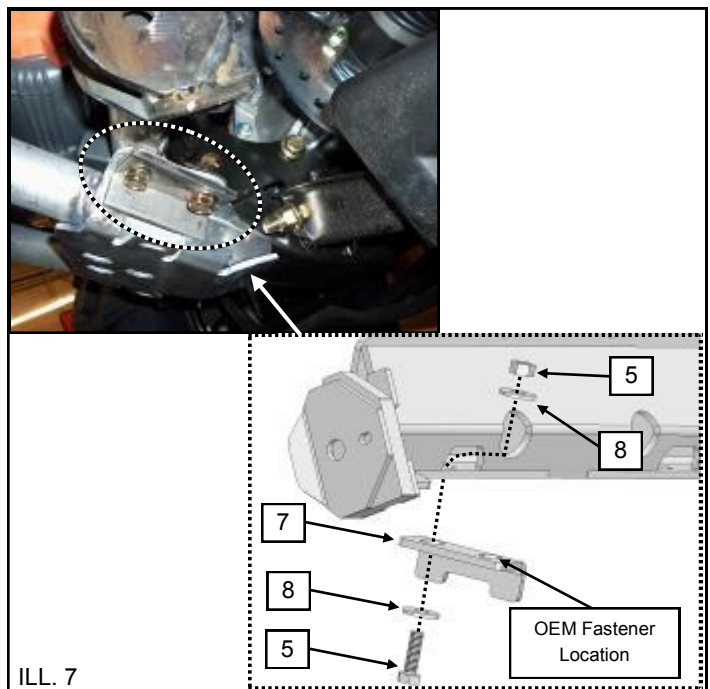



- Reinstall all previously removed body components onto the ATV.

INSTALLING MOUNT BRACKETS TO THE PUSH TUBE:

- Place the left and right brackets, Items #10 and #12, onto push tube 16-0000 as shown in Illustration 8. Place washers, Items #8 and #9, over the holes and fasten to the push tube using carriage bolts, Items #3 and #4 and locknuts, Items #5 and #6.

Torque fasteners to specification.

 = T
ITEM #3 - FASTENER TORQUE: 17 ft. lbs. (23 Nm)
 = T
ITEM #4 - FASTENER TORQUE: 30 ft. lbs. (41 Nm)

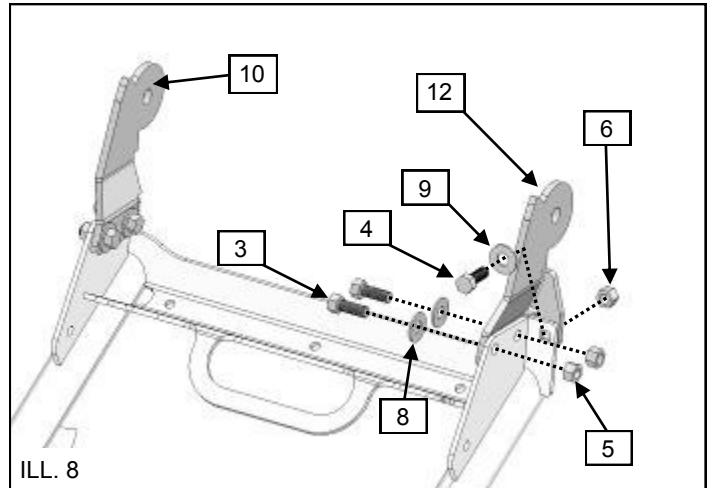

ATTACHING PUSH TUBE TO FRONT MOUNT:

- Place the assembled left and right brackets into the mount as shown. Verify they are seated properly. Insert quick-release pins, Item #11 into the holes. See Illustration 9. *To remove the push tube, reverse the procedure.*

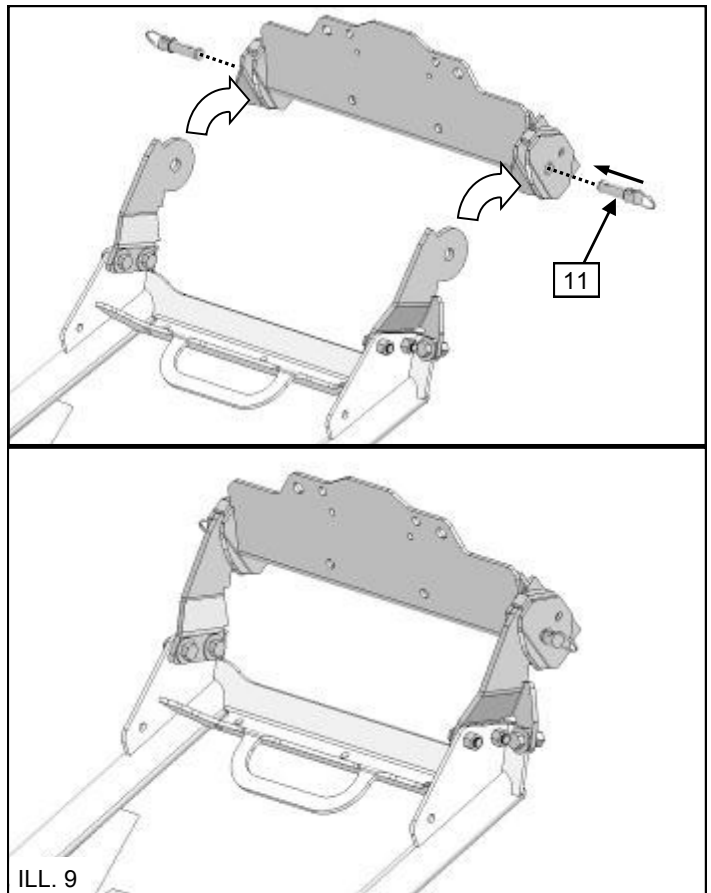



One Year Limited Warranty

For the period of one (1) year from the purchase date, Cycle Country (a Kolpin Powersports Brand) will replace for the original purchaser, free of charge, any part or parts found upon examination by Cycle Country to be defective in material, workmanship, or both.

All transportation costs incurred submitting product to Cycle Country for warranty consideration must be borne by the purchaser. If Cycle Country determines that the product must be returned to the factory for credit, please call 1-800-841-2222 for a Return Merchandise Authorization (RMA) number and shipping instructions.

This warranty does not apply to parts that have been damaged by accident, alteration, abuse, improper maintenance, normal wear, or other causes beyond the manufacturer's control. In order to protect you and your ATV, certain parts of the plow system and/or hardware are designed to fail when the equipment is over-stressed.

Peripheral products such as engines, electric motors, and actuators may carry an original manufacturer's warranty. Please call Cycle Country for more information.

CYCLE COUNTRY

A KOLPIN POWERSPORTS BRAND

205 N DEPOT ST

PO BOX 107

FOX LAKE, WI 53933

SERVICE: 800-841-2222

FAX: 1-800-245-7569

E-MAIL: ccac@cyclecountry.com

WEB: www.cyclecountry.com

© 2012 Cycle Country Accessories Corporation