



ATV WP2 FRONT MOUNT KIT

For POLARIS 550 / 850

ASSEMBLY / OWNER'S MANUAL

Part No: 16-3020

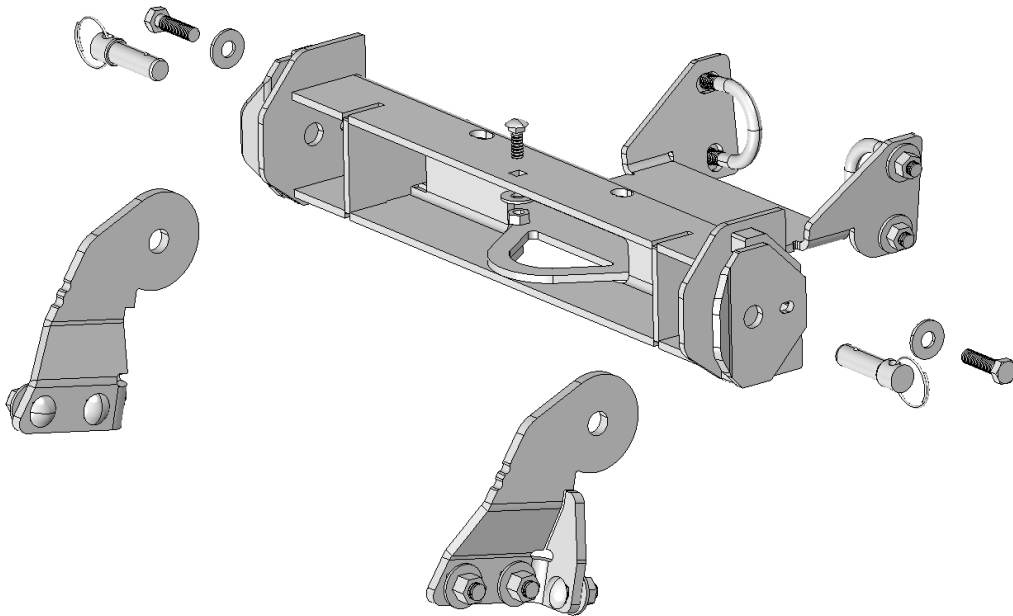

OPERATING INSTRUCTIONS

Congratulations! You've just purchased the most durable plow component in the industry. Cycle Country plow components work great for summer or winter plowing. With proper care and maintenance, your Cycle Country plow system will last for years to come!

NOTICE
<p>ATV WP2 Plow systems require additional components for operation*</p> <p>Cycle Country Plow Blade</p> <p>Cycle Country WP2 Push Tube Kit</p> <p>Cycle Country Lift System (Winch Kit, Electric Lift)</p> <p><small>* WP2 Front Mount Kits are vehicle-specific. To find your specific application, use the 'Search by Vehicle' function at www.cyclecountry.com</small></p>

Please read and understand all assembly instructions, notices and warnings before assembling and operating your Cycle Country plow system.

Follow these guidelines to ensure satisfactory operation:

- Periodically check for wear and tightness of all fasteners. Replace or re-torque fasteners as necessary.
- Read this manual and your ATV operators manual before use.
- Before first use, set plow in the furthest right or left angled position to check for interference with the vehicle.
- Operate with extreme caution on slopes and rough terrain. Be familiar with the area before you plow.
- Be aware of immovable objects that could be hidden in the dirt, gravel or snow you are plowing.
- To avoid damage when plowing dirt, gravel or snow into a pile, reverse direction before raising the plow blade.
- Do not ram the plow into piles of dirt, gravel or snow, as damage to the plow system or vehicle may result.

A complete operator's guide can be downloaded for free at www.cyclecountry.com. This guide contains beginner-to-advanced information regarding plow systems and operation.

SAFETY INFORMATION

Cycle Country plow systems were designed with your safety in mind. In order to protect you and your vehicle, certain parts of the plow system and/or hardware are designed to fail when the equipment is over-stressed.

 WARNING
<p>To avoid personal injury or damage to your vehicle:</p> <p>Do not exceed 5 mph (8 kph) with the blade installed</p> <p>Be aware that vehicle ground clearance is reduced with plow system installed</p> <p>Keep yourself, other people and pets away from the blade and moving parts during operation</p> <p>Before adjusting blade angle or disconnecting the plow system, stop the engine and set the parking brake</p> <p>Remove your plow system before trail riding</p> <p>Do not ram the plow system into piles of dirt, gravel or snow</p>

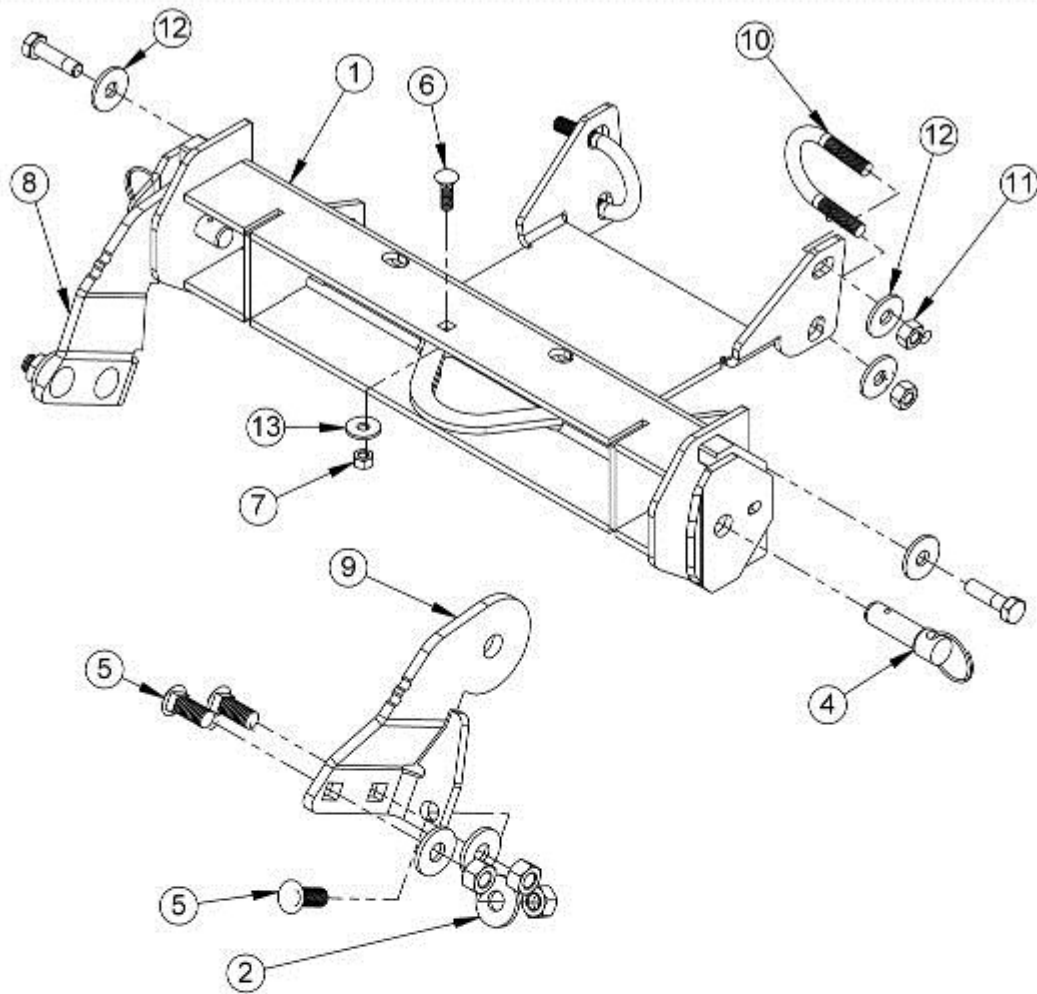

Model Number 16-3020 Parts List

ITEM NO.	QTY.	PART NO.	DESCRIPTION
1	1	CYC6110	Front Mount Weldment
2	6	PUR3088	Flat Washer 10mm
3	6	PUR3069	Nylon Lock Nut M10
4	2	PUR2497	Quick Release Pin 1 x .5
5	6	PUR3060	Carriage Bolt M10 x 25mm
6	1	PUR3046	Carriage Bolt M6 x 20mm
7	1	PUR3067	Nylon Lock Nut M6
8	1	CYC2199	Bracket Right
9	1	CYC2198	Bracket Left
10	2	PUR3191	U-bolt 8mm x 35mm x 50mm
11	4	PUR3068	Nylon Lock Nut M8
12	6	PUR3087	Flat Washer 8mm
13	1	PUR3086	Flat Washer 6mm
14	2	PUR3013	Metric Bolt 8 x 30mm

Hardware Package CYC6114

PARTS ORDERING INFORMATION:

Replacement fasteners are common-type
and can be purchased locally. Use minimum Grade 5 zinc-coated fasteners.

BEFORE YOU BEGIN:

- Please read and understand all instructions.
- Verify all parts and tools are accounted for.
- To ensure a satisfactory installation, follow all steps correctly and in the sequence described.
- All directions referring to right and left are when the rider is sitting on the machine

TOOLS REQUIRED:

- Basic Hand Wrench and Socket Set
- Torque Wrench
- Drill
- Drill Bit Set
- Plastic Trimming Tool

INSTALLATION NOTES:

NOTICE

16-3020 may not be compatible with some aftermarket winch mounts. To insure compatibility, install Cycle Country Winch Mount 25-3320.

NOTICE

Trimming and drilling of lower front plastic components is required to complete installation. Use caution against removing too much material. Mark hole location before drilling.

INSTALLATION OF MOUNT:

1. Remove the lower guard from the ATV. See Illustration 1. Retain the OEM fasteners.

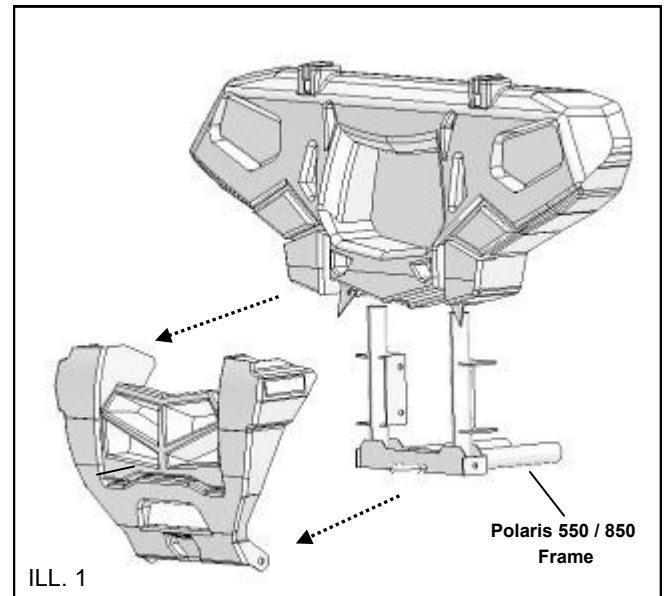

2. Place the front mount weldment, Item #1, onto the front of the frame, centering it between the frame tubes and allowing the tow hook to protrude through the center section. See Illustration 2.

3. Place washers, Item #12 over the rear mount slotted holes. Install U-bolts, Item #10, around the frame tubes and through the mount. Fasten with lock nuts, Item #11. Do not tighten at this time. See Illustration 2.

4. Place washers, Item #12 over the front mount slotted holes. Install bolts, Item #14, around the frame tubes and through the mount. See Illustration 2.

5. Torque all fasteners to specification.

 = T
FASTENER TORQUE: 17 ft. lbs. (23 Nm)

6. Trim the lower guard according to the guidelines shown in Illustration 3, removing small amounts of material at a time. Repeatedly check fit.

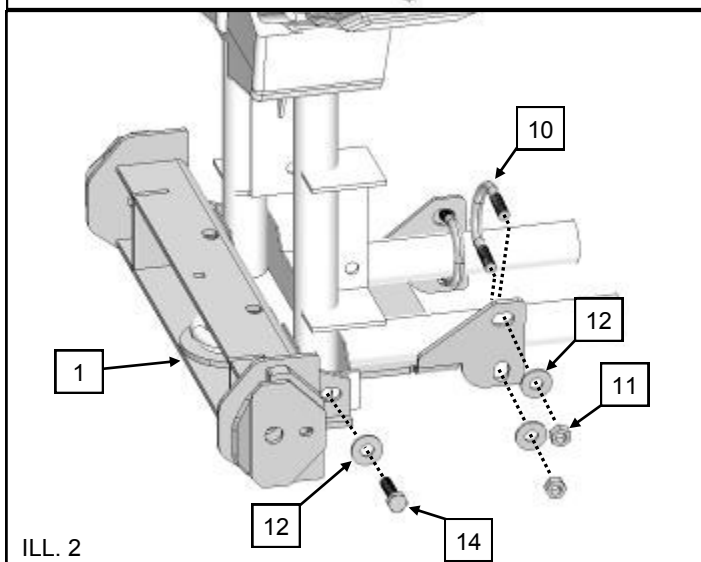
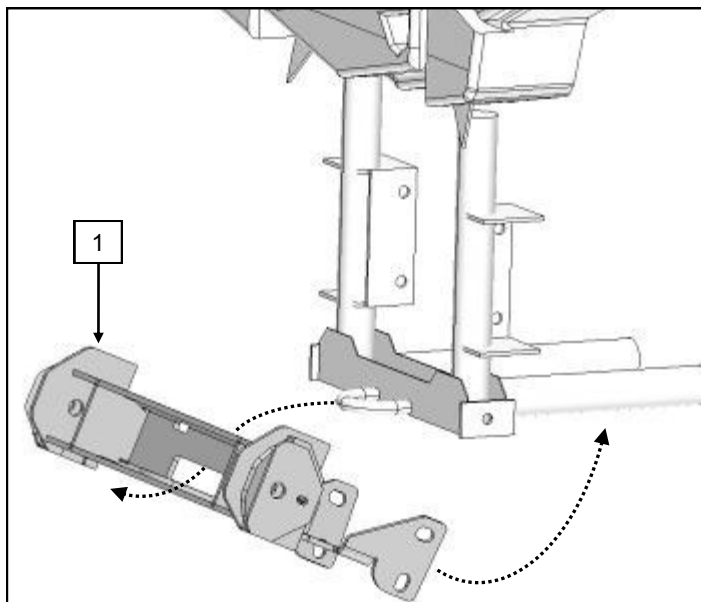

ILL. 2

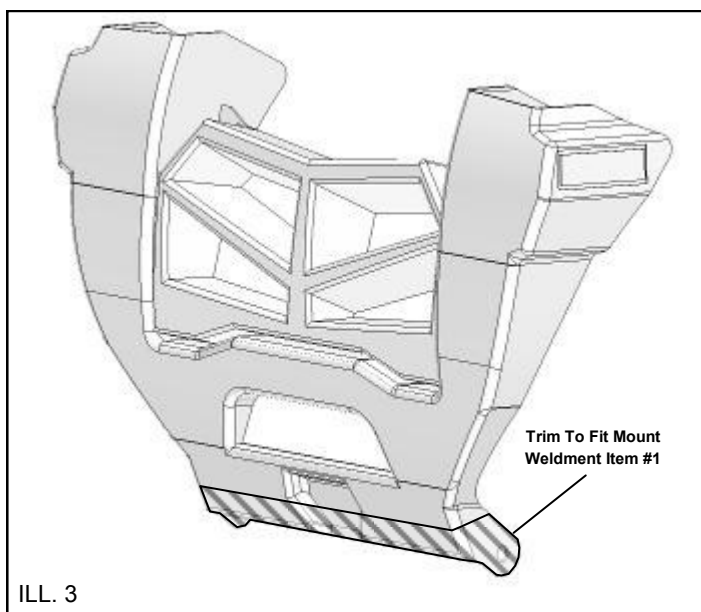

ILL. 3

7. With the lower guard fitted to the mount center section, mark the guard at the square support hole location and drill the hole location with a 3/8" drill bit. See Illustration 4.
8. After drilling the hole, re-install the front plastic, using the OEM fasteners at the top of the guard.
9. Place washer, Item #13 over the drilled hole. Fasten the lower guard to the mount with carriage bolt, Item #6 and lock nut, Item #7. Tighten sufficiently. See Illustration 4.

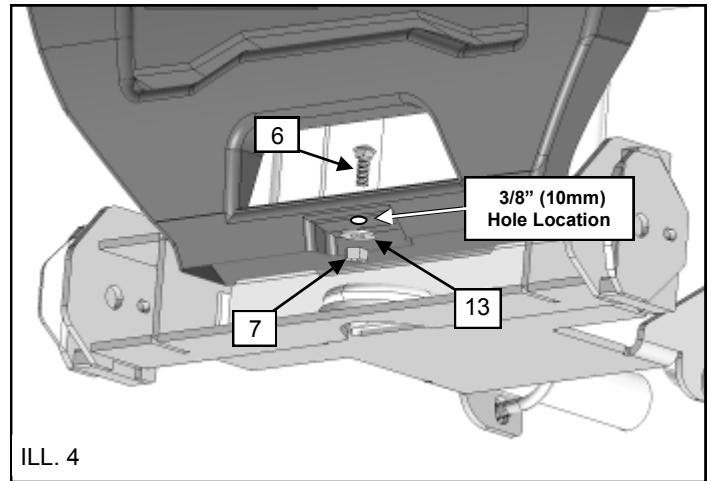

ILL. 4

INSTALLING MOUNT BRACKETS TO THE PUSH TUBE:

1. Place the left and right brackets, Items #8 and #9, onto push tube 16-0000 as shown in Illustration 5. Place washers, Item #2, over the holes and fasten to the push tube using carriage bolts, Item #5 and locknuts, Item #3.

Torque fasteners to specification.

 = T
FASTENER TORQUE: 30 ft. lbs. (41 Nm)

ATTACHING PUSH TUBE TO FRONT MOUNT:

1. Place the assembled left and right brackets into the mount as shown. Verify they are seated properly. Insert quick-release pins, Item #4 into the holes. See Illustration 6. *To remove the push tube, reverse the procedure.*

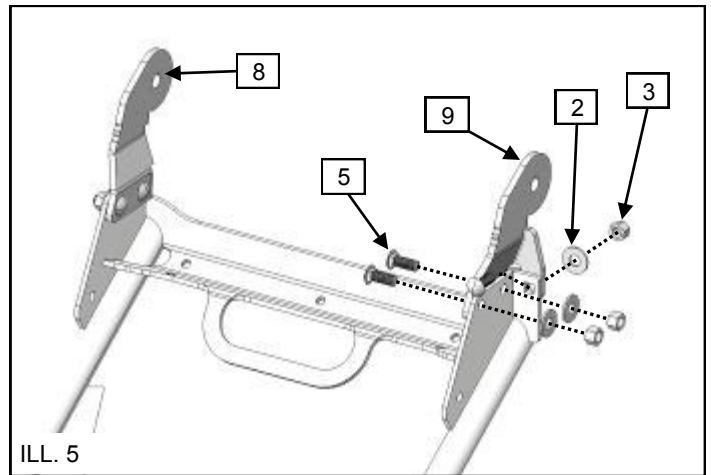

ILL. 5

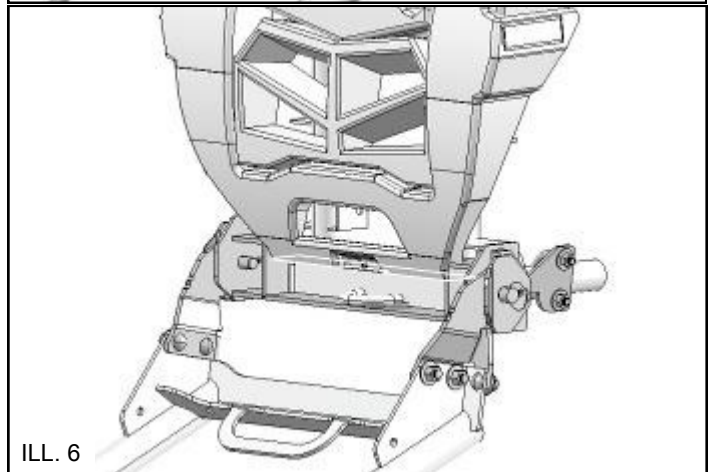
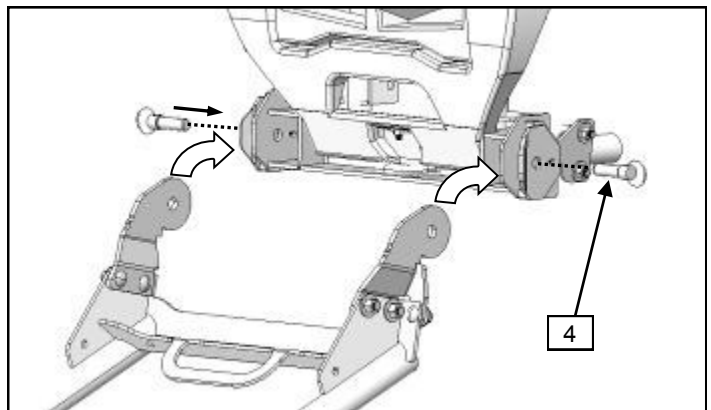

ILL. 6



One Year Limited Warranty

For the period of one (1) year from the purchase date, Cycle Country (a Kolpin Powersports Brand) will replace for the original purchaser, free of charge, any part or parts found upon examination by Cycle Country to be defective in material, workmanship, or both.

All transportation costs incurred submitting product to Cycle Country for warranty consideration must be borne by the purchaser. If Cycle Country determines that the product must be returned to the factory for credit, please call 1-800-841-2222 for a Return Merchandise Authorization (RMA) number and shipping instructions.

This warranty does not apply to parts that have been damaged by accident, alteration, abuse, improper maintenance, normal wear, or other causes beyond the manufacturer's control. In order to protect you and your ATV, certain parts of the plow system and/or hardware are designed to fail when the equipment is over-stressed.

Peripheral products such as engines, electric motors, and actuators may carry an original manufacturer's warranty. Please call Cycle Country for more information.

CYCLE COUNTRY

A KOLPIN POWERSPORTS BRAND

205 N DEPOT ST

PO BOX 107

FOX LAKE, WI 53933

SERVICE: 800-841-2222

FAX: 1-800-245-7569

E-MAIL: ccac@cyclecountry.com

WEB: www.cyclecountry.com

© 2012 Cycle Country Accessories Corporation